



MOON
Cutter Co., Inc.



**The Leader in Milling Cutters,
Keyseat Cutters, and Saws**

- Made by Skilled Americans -

In Loving Memory
Our Founder and Our Father
Charlie D. Moon
1927-2003



*A SKILLED CRAFTSMEN THAT GROUND THE SHARP CORNERS ON THE INDUSTRY
BY SETTING THE STANDARD OF QUALITY MILLING CUTTERS FOR GENERATIONS TO COME.*

When Charlie D. Moon founded the Moon Cutter Co., Inc. in 1957, he envisioned a company that would ensure satisfaction through four basic qualities: competitive prices, speedy delivery, strong customer relations through superior customer service, and engineering the highest quality of milling cutters available. Almost fifty years later, it is still these qualities which have enabled our company to grow successfully for three generations and continue to be your **Leader in Milling Cutters, Keyseat Cutters and Saws.**

The entire Moon family is dedicated to working hard every day to ensure that the long family tradition of service and quality is upheld and the ideology of our father carries over in every aspect of our production. We thank you for your support and consideration. If there is anything we can do for your next cutting tool project please feel free to call and ask for a MOON family expert.

Whether you need a standard tool, alterations to standard tools, or a full blueprint special, our total in-house capabilities will assure you the highest quality tools at the best price, delivered fast and with the personal attention your projects deserve.

Terms and Conditions

Sales Policy: as active members of the Industrial Supply Manufacturers Association (ISMA), we support the value-added services of our partners in industrial distribution. Our products are exclusively sold through selected, authorized industrial distributors who meet our high standards of business ethics and customer service capabilities.



Payment Terms and Prices: net 30 days. Accounts in arrears are subject to both shipment hold and production hold. Prices for special tools are subject to re quoting after 30 days; catalog prices are subject to change without notice. C.O.D. shipments are sent by U.P.S. and C.O.D. Payments are cash, certified check, money order or MC/VISA.

Cancellations: cancellation of orders for "standard catalog product" can be made at no charge providing the tools have not been shipped and we have not incurred labor expenses to finish a specific size or altered standard markings or packaging. A cancellation fee will be charged in proportion to the amount of the cost accumulated on the order prior to cancellation.

Shipping Terms: freight is F.O.B. shipping point. Ground and air shipments ship United Parcel Service unless otherwise specified.



Customer Alterations: Moon Cutter Co., Inc. cannot be responsible for the performance of, or compliance with, specifications, nor can we accept for return, any tool that has been altered in any way by our customers. This includes: surface treatments, coatings, flats, tangs, markings, or any geometric alterations. Any tools altered are non-returnable and voids all warranties.

Over or Undershipments: unless your order specifies "no overshipments," Moon Cutter Co., Inc. policy follows standard industry practice on altered standard and special orders, which is to start +10% over the quantity ordered. We will ship and bill the quantity completed, which could be as much as 10% over or 10% under the quantity ordered. On quantities from one piece to nine pieces, our standard shipping tolerance is plus or minus one piece. Orders for special tooling that specify "no over and no under shipments" (exact quantities) are subject to a premium charge.

Product Warranty: we guarantee our products will conform to the dimensions listed on customer blueprints, orders, and quotation requests. Dimensions, specifications, and tolerances not listed will be furnished to the current United States Cutting Tool Institute manufacturing standards. Our warranty is limited to repair, replacement, or full credit for the tools found not to be within specifications, at our option.



Returned Goods: all returned goods must have a "returned goods authorization number" (RGA). Contact our customer service department to obtain a returned goods authorization number (RGA) prior to returning any material. To ensure proper credit, all returned products must be in clean, resalable condition and in the original packaging. We cannot accept any product that has been discontinued or in quantities that are unusually large as compared to Moon's average sales for any particular item. **Note:** special tools are not returnable.

Photo Index



Side Milling Cutters

	Straight Tooth.....6-8
	Full Radius.....21
	Staggered Tooth.....9-11
	Full Radius.....21

Cobalt Side Milling Cutters

	Straight Tooth.....12
	Full Radius.....21
	Staggered Tooth.....12
	Full Radius.....21

Shell End Mills

	General Purpose.....13
	Aluminum.....13
	Cobalt.....13

Carbide Tipped Side Milling Cutters

	For Cast Iron.....14
	For Non-Ferrous.....14
	For Steel.....15

Concave Radius Milling Cutters

	H.S.S. and Cobalt.....25
---	--------------------------

Convex Radius Milling Cutters

	H.S.S. and Cobalt.....25
	Carbide Tipped.....25



High Speed Steel (H.S.S.) Combined Drills

	and Countersinks.....15
---	-------------------------

Corner Rounding End Mills

	H.S.S. and Cobalt.....16
--	--------------------------

T-Slot Cutters

	H.S.S. and Cobalt.....17
	Carbide Tipped.....16

Extended Shank T-Slot Cutters

	H.S.S. and Cobalt.....17
--	--------------------------

Dovetail Cutters



	H.S.S. and Cobalt.....18
	Carbide Tipped.....18

Photo Index

Face Angle Chamfer Milling Cutters



H.S.S. and Cobalt 18

Double Angle Cutters



H.S.S. and Carbide Tipped..... 19

Chamfer Tools



H.S.S. and Carbide Tipped..... 19

Angle Milling Cutters



Single Angle..... 20



Double Angle..... 20

Woodruff Keyseat Cutters



Large Diameter

H.S.S. and Cobalt 25



American Standard – straight and staggered

H.S.S. and Cobalt 22



Carbide Tipped 22

Solid Carbide..... 22



Full Radius

H.S.S. and Cobalt 24



Narrow Width

H.S.S. and Cobalt 23



Arbor Type 26

Plain Milling Cutters



Light Duty 27



Heavy Duty 27

Half Side Milling Cutters



Right Hand 28



Left Hand 28

Metal Slitting Saws



Straight Tooth 29



Full Radius..... 21



Staggered Tooth 30



Concave Sides 31

Cobalt Slitting Saws



Straight Tooth 32



Staggered Tooth..... 32

Feeds & Speeds 35

Side Milling Cutters



**CORNER RADIUS-ALTERED WIDTH
ALL TOOLS IN THIS CATALOG
CAN BE ALTERED AND SHIPPED
IN LESS THAN 48 HOURS**

For Cobalt see page 12.
Full Radius see page 21.

Straight Tooth

All cutters with the same amount of teeth can be interlocked by specifying "A" or "B" cutters and grinding the hubs.

Catalog No.	Cutter Diam.	Width	Hole Size	No. of Teeth
SM2187	2	3/16	5/8	14
SM2250	2	1/4	5/8	14
SM2375	2	3/8	5/8	14
SM25250	2-1/2	1/4	7/8	18
SM25312	2-1/2	5/16	7/8	18
SM25375	2-1/2	3/8	7/8	18
SM25500	2-1/2	1/2	7/8	18
SM3187	3	3/16	1	20
SM3187-1	3	3/16	1-1/4	20
SM3218	3	7/32	1	20
SM3218-1	3	7/32	1-1/4	20
SM3250	3	1/4	1	20
SM3250-1	3	1/4	1-1/4	20
SM3281	3	9/32	1	20
SM3281-1	3	9/32	1-1/4	20
SM3312	3	5/16	1	20
SM3312-1	3	5/16	1-1/4	20
SM3343	3	11/32	1	20
SM3343-1	3	11/32	1-1/4	20
SM3375	3	3/8	1	20
SM3375-1	3	3/8	1-1/4	20
SM3406	3	13/32	1	20
SM3406-1	3	13/32	1-1/4	20
SM3437	3	7/16	1	20
SM3437-1	3	7/16	1-1/4	20
SM3500	3	1/2	1	20
SM3500-1	3	1/2	1-1/4	20
SM3562	3	9/16	1	20
SM3562-1	3	9/16	1-1/4	20
SM3625	3	5/8	1	20
SM3625-1	3	5/8	1-1/4	20
SM3687	3	11/16	1	20

Catalog No.	Cutter Diam.	Width	Hole Size	No. of Teeth
SM3687-1	3	11/16	1-1/4	20
SM3750	3	3/4	1	20
SM3750-1	3	3/4	1-1/4	20
SM3812	3	13/16	1	20
SM3812-1	3	13/16	1-1/4	20
SM3875	3	7/8	1	20
SM3875-1	3	7/8	1-1/4	20
SM3937	3	15/16	1	20
SM3937-1	3	15/16	1-1/4	20
SM3100	3	1	1	20
SM3100-1	3	1	1-1/4	20
SM35187-20T	3-1/2	3/16	1	20
SM35187-24T	3-1/2	3/16	1	24
SM35187-1-20T	3-1/2	3/16	1-1/4	20
SM35187-1-24T	3-1/2	3/16	1-1/4	24
SM35218-24T	3-1/2	7/32	1	24
SM35218-1-24T	3-1/2	7/32	1-1/4	24
SM35250-20T	3-1/2	1/4	1	20
SM35250-24T	3-1/2	1/4	1	24
SM35250-1-20T	3-1/2	1/4	1-1/4	20
SM35250-1-24T	3-1/2	1/4	1-1/4	24
SM35281-1-24T	3-1/2	9/32	1-1/4	24
SM35312-20T	3-1/2	5/16	1	20
SM35312-24T	3-1/2	5/16	1	24
SM35312-1-20T	3-1/2	5/16	1-1/4	20
SM35312-1-24T	3-1/2	5/16	1-1/4	24
SM35343-24T	3-1/2	11/32	1	24
SM35343-1-20T	3-1/2	11/32	1-1/4	20
SM35343-1-24T	3-1/2	11/32	1-1/4	24
SM35375-20T	3-1/2	3/8	1	20
SM35375-24T	3-1/2	3/8	1	24
SM35375-1-20T	3-1/2	3/8	1-1/4	20
SM35375-1-24T	3-1/2	3/8	1-1/4	24
SM35406-20T	3-1/2	13/32	1	20
SM35406-24T	3-1/2	13/32	1	24
SM35406-1-20T	3-1/2	13/32	1-1/4	20
SM35406-1-24T	3-1/2	13/32	1-1/4	24
SM35437-20T	3-1/2	7/16	1	20
SM35437-24T	3-1/2	7/16	1	24
SM35437-1-20T	3-1/2	7/16	1-1/4	20
SM35437-1-24T	3-1/2	7/16	1-1/4	24
SM35500-20T	3-1/2	1/2	1	20
SM35500-24T	3-1/2	1/2	1	24
SM35500-1-20T	3-1/2	1/2	1-1/4	20
SM35500-1-24T	3-1/2	1/2	1-1/4	24
SM35562-20T	3-1/2	9/16	1	20
SM35562-24T	3-1/2	9/16	1	24
SM35562-1-20T	3-1/2	9/16	1-1/4	20
SM35562-1-24T	3-1/2	9/16	1-1/4	24
SM35625-20T	3-1/2	5/8	1	20
SM35625-24T	3-1/2	5/8	1	24
SM35625-1-20T	3-1/2	5/8	1-1/4	20
SM35625-1-24T	3-1/2	5/8	1-1/4	24
SM35687-20T	3-1/2	11/16	1	20
SM35687-24T	3-1/2	11/16	1	24
SM35687-1-20T	3-1/2	11/16	1-1/4	20
SM35687-1-24T	3-1/2	11/16	1-1/4	24
SM35750-20T	3-1/2	3/4	1	20

Side Milling Cutters

Straight Tooth (continued)

Catalog No.	Cutter Diam.	Width	Hole Size	No. of Teeth
SM35750-24T	3-1/2	3/4	1	24
SM35750-1-20T	3-1/2	3/4	1-1/4	20
SM35750-1-24T	3-1/2	3/4	1-1/4	24
SM35812-20T	3-1/2	13/16	1	20
SM35812-24T	3-1/2	13/16	1	24
SM35812-1-20T	3-1/2	13/16	1-1/4	20
SM35812-1-24T	3-1/2	13/16	1-1/4	24
SM35875-20T	3-1/2	7/8	1	20
SM35875-24T	3-1/2	7/8	1	24
SM35875-1-20T	3-1/2	7/8	1-1/4	20
SM35875-1-24T	3-1/2	7/8	1-1/4	24
SM35937-20T	3-1/2	15/16	1	20
SM35937-24T	3-1/2	15/16	1	24
SM35937-1-20T	3-1/2	15/16	1-1/4	20
SM35937-1-24T	3-1/2	15/16	1-1/4	24
SM35100-20T	3-1/2	1	1	20
SM35100-24T	3-1/2	1	1	24
SM35100-1-20T	3-1/2	1	1-1/4	20
SM35100-1-24T	3-1/2	1	1-1/4	24
SM4187	4	3/16	1	24
SM4187-1	4	3/16	1-1/4	24
SM4218	4	7/32	1	24
SM4218-1	4	7/32	1-1/4	24
SM4250	4	1/4	1	24
SM4250-1	4	1/4	1-1/4	24
SM4281	4	9/32	1	24
SM4281-1	4	9/32	1-1/4	24
SM4312	4	5/16	1	24
SM4312-1	4	5/16	1-1/4	24
SM4343	4	11/32	1	24
SM4343-1	4	11/32	1-1/4	24
SM4375	4	3/8	1	24
SM4375-1	4	3/8	1-1/4	24
SM4406	4	13/32	1	24
SM4406-1	4	13/32	1-1/4	24
SM4437	4	7/16	1	24
SM4437-1	4	7/16	1-1/4	24
SM4500	4	1/2	1	24
SM4500-1	4	1/2	1-1/4	24
SM4562	4	9/16	1	24
SM4562-1	4	9/16	1-1/4	24
SM4625	4	5/8	1	24
SM4625-1	4	5/8	1-1/4	24
SM4687	4	11/16	1	24
SM4687-1	4	11/16	1-1/4	24
SM4750	4	3/4	1	24
SM4750-1	4	3/4	1-1/4	24
SM4812	4	13/16	1	24
SM4812-1	4	13/16	1-1/4	24
SM4875	4	7/8	1	24
SM4875-1	4	7/8	1-1/4	24
SM4937	4	15/16	1	24
SM4937-1	4	15/16	1-1/4	24
SM4100	4	1	1	24
SM4100-1	4	1	1-1/4	24
SM45187	4-1/2	3/16	1	24

Catalog No.	Cutter Diam.	Width	Hole Size	No. of Teeth
SM45187-1	4-1/2	3/16	1-1/4	24
SM45218	4-1/2	7/32	1	24
SM45218-1	4-1/2	7/32	1-1/4	24
SM45250	4-1/2	1/4	1	24
SM45250-1	4-1/2	1/4	1-1/4	24
SM45281	4-1/2	9/32	1	24
SM45281-1	4-1/2	9/32	1-1/4	24
SM45312	4-1/2	5/16	1	24
SM45312-1	4-1/2	5/16	1-1/4	24
SM45343	4-1/2	11/32	1	24
SM45343-1	4-1/2	11/32	1-1/4	24
SM45375	4-1/2	3/8	1	24
SM45375-1	4-1/2	3/8	1-1/4	24
SM45406	4-1/2	13/32	1	24
SM45406-1	4-1/2	13/32	1-1/4	24
SM45437	4-1/2	7/16	1	24
SM45437-1	4-1/2	7/16	1-1/4	24
SM45500	4-1/2	1/2	1	24
SM45500-1	4-1/2	1/2	1-1/4	24
SM45562	4-1/2	9/16	1	24
SM45562-1	4-1/2	9/16	1-1/4	24
SM45625	4-1/2	5/8	1	24
SM45625-1	4-1/2	5/8	1-1/4	24
SM45687	4-1/2	11/16	1	24
SM45687-1	4-1/2	11/16	1-1/4	24
SM45750	4-1/2	3/4	1	24
SM45750-1	4-1/2	3/4	1-1/4	24
SM45812	4-1/2	13/16	1	24
SM45812-1	4-1/2	13/16	1-1/4	24
SM45875	4-1/2	7/8	1	24
SM45875-1	4-1/2	7/8	1-1/4	24
SM45937	4-1/2	15/16	1	24
SM45937-1	4-1/2	15/16	1-1/4	24
SM45100	4-1/2	1	1	24
SM45100-1	4-1/2	1	1-1/4	24
SM5187	5	3/16	1	24
SM5187-1	5	3/16	1-1/4	24
SM5218	5	7/32	1	24
SM5218-1	5	7/32	1-1/4	24
SM5250	5	1/4	1	24
SM5250-1	5	1/4	1-1/4	24
SM5281	5	9/32	1	24
SM5281-1	5	9/32	1-1/4	24
SM5312	5	5/16	1	24
SM5312-1	5	5/16	1-1/4	24
SM5343	5	11/32	1	24
SM5343-1	5	11/32	1-1/4	24
SM5375	5	3/8	1	24
SM5375-1	5	3/8	1-1/4	24
SM5406	5	13/32	1	24
SM5406-1	5	13/32	1-1/4	24
SM5437	5	7/16	1	24
SM5437-1	5	7/16	1-1/4	24
SM5500	5	1/2	1	24
SM5500-1	5	1/2	1-1/4	24
SM5562	5	9/16	1	24
SM5562-1	5	9/16	1-1/4	24
SM5625	5	5/8	1	24

Side Milling Cutters

Straight Tooth (continued)

Catalog No.	Cutter Diam.	Width	Hole Size	No. of Teeth
SM5625-1	5	5/8	1-1/4	24
SM5687	5	11/16	1	24
SM5687-1	5	11/16	1-1/4	24
SM5750	5	3/4	1	24
SM5750-1	5	3/4	1-1/4	24
SM5812	5	13/16	1	24
SM5812-1	5	13/16	1-1/4	24
SM5875	5	7/8	1	24
SM5875-1	5	7/8	1-1/4	24
SM5937	5	15/16	1	24
SM5937-1	5	15/16	1-1/4	24
SM5100	5	1	1	24
SM5100-1	5	1	1-1/4	24
SM55187-24T	5-1/2	3/16	1	24
SM55187-28T	5-1/2	3/16	1	28
SM55187-1-24T	5-1/2	3/16	1-1/4	24
SM55187-1-28T	5-1/2	3/16	1-1/4	28
SM55250-24T	5-1/2	1/4	1	24
SM55250-28T	5-1/2	1/4	1	28
SM55250-1-24T	5-1/2	1/4	1-1/4	24
SM55250-1-28T	5-1/2	1/4	1-1/4	28
SM55312-24T	5-1/2	5/16	1	24
SM55312-28T	5-1/2	5/16	1	28
SM55312-1-24T	5-1/2	5/16	1-1/4	24
SM55312-1-28T	5-1/2	5/16	1-1/4	28
SM55375-24T	5-1/2	3/8	1	24
SM55375-28T	5-1/2	3/8	1	28
SM55375-1-24T	5-1/2	3/8	1-1/4	24
SM55375-1-28T	5-1/2	3/8	1-1/4	28
SM55437-24T	5-1/2	7/16	1	24
SM55437-28T	5-1/2	7/16	1	28
SM55437-1-24T	5-1/2	7/16	1-1/4	24
SM55437-1-28T	5-1/2	7/16	1-1/4	28
SM55500-24T	5-1/2	1/2	1	24
SM55500-28T	5-1/2	1/2	1	28
SM55500-1-24T	5-1/2	1/2	1-1/4	24
SM55500-1-28T	5-1/2	1/2	1-1/4	28
SM55562-24T	5-1/2	9/16	1	24
SM55562-28T	5-1/2	9/16	1	28
SM55562-1-24T	5-1/2	9/16	1-1/4	24
SM55562-1-28T	5-1/2	9/16	1-1/4	28
SM55625-24T	5-1/2	5/8	1	24
SM55625-28T	5-1/2	5/8	1	28
SM55625-1-24T	5-1/2	5/8	1-1/4	24
SM55625-1-28T	5-1/2	5/8	1-1/4	28
SM55687-24T	5-1/2	11/16	1	24
SM55687-28T	5-1/2	11/16	1	28
SM55687-1-24T	5-1/2	11/16	1-1/4	24
SM55687-1-28T	5-1/2	11/16	1-1/4	28
SM55750-24T	5-1/2	3/4	1	24
SM55750-28T	5-1/2	3/4	1	28
SM55750-1-24T	5-1/2	3/4	1-1/4	24
SM55750-1-28T	5-1/2	3/4	1-1/4	28
SM55812-24T	5-1/2	13/16	1	24
SM55812-28T	5-1/2	13/16	1	28
SM58812-1-24T	5-1/2	13/16	1-1/4	24
SM55812-1-28T	5-1/2	13/16	1-1/4	28

Catalog No.	Cutter Diam.	Width	Hole Size	No. of Teeth
SM55875-24T	5-1/2	7/8	1	24
SM55875-28T	5-1/2	7/8	1	28
SM55875-1-24T	5-1/2	7/8	1-1/4	24
SM55875-1-28T	5-1/2	7/8	1-1/4	28
SM55937-24T	5-1/2	15/16	1	24
SM55937-28T	5-1/2	15/16	1	28
SM55937-1-24T	5-1/2	15/16	1-1/4	24
SM55937-1-28T	5-1/2	15/16	1-1/4	28
SM55100-24T	5-1/2	1	1	24
SM55100-28T	5-1/2	1	1	28
SM55100-1-24T	5-1/2	1	1-1/4	24
SM55100-1-28T	5-1/2	1	1-1/4	28
SM6187	6	3/16	1	28
SM6187-1	6	3/16	1-1/4	28
SM6218	6	7/32	1	28
SM6218-1	6	7/32	1-1/4	28
SM6250	6	1/4	1	28
SM6250-1	6	1/4	1-1/4	28
SM6281	6	9/32	1	28
SM6281-1	6	9/32	1-1/4	28
SM6312	6	5/16	1	28
SM6312-1	6	5/16	1-1/4	28
SM6343	6	11/32	1	28
SM6343-1	6	11/32	1-1/4	28
SM6375	6	3/8	1	28
SM6375-1	6	3/8	1-1/4	28
SM6406	6	13/32	1	28
SM6406-1	6	13/32	1-1/4	28
SM6437	6	7/16	1	28
SM6437-1	6	7/16	1-1/4	28
SM6500	6	1/2	1	28
SM6500-1	6	1/2	1-1/4	28
SM6562	6	9/16	1	28
SM6562-1	6	9/16	1-1/4	28
SM6625	6	5/8	1	28
SM6625-1	6	5/8	1-1/4	28
SM6687	6	11/16	1	28
SM6687-1	6	11/16	1-1/4	28
SM6750	6	3/4	1	28
SM6750-1	6	3/4	1-1/4	28
SM6812	6	13/16	1	28
SM6812-1	6	13/16	1-1/4	28
SM6875	6	7/8	1	28
SM6875-1	6	7/8	1-1/4	28
SM6937	6	15/16	1	28
SM6937-1	6	15/16	1-1/4	28
SM6100	6	1	1	28
SM6100-1	6	1	1-1/4	28
SM7500-1	7	1/2	1-1/4	28
SM7625-1	7	5/8	1-1/4	28
SM7750-1	7	3/4	1-1/4	28
SM7100-1	7	1	1-1/4	28
SM8312-1	8	5/16	1-1/4	34
SM8375-1	8	3/8	1-1/4	34
SM8500-1	8	1/2	1-1/4	34
SM8750-1	8	3/4	1-1/4	34
SM8750-2	8	3/4	1-1/2	34
SM8100-1	8	1	1-1/4	34

Side Milling Cutters

CORNER RADIUS-ALTERED WIDTH
ALL TOOLS IN THIS CATALOG
CAN BE ALTERED AND SHIPPED
IN LESS THAN 48 HOURS

Staggered Tooth

Please specify the number of teeth desired when ordering these cutters. All Staggered Tooth Cutters with the same amount of teeth can be interlocked by grinding hubs.



For cobalt see page 12. Full Radius see page 21.

Catalog No.	Cutter Diam.	Width	Hole Size	No. of Teeth
STM25250	2-1/2	1/4	7/8	16
STM25312	2-1/2	5/16	7/8	16
STM25375	2-1/2	3/8	7/8	16
STM25500	2-1/2	1/2	7/8	16
STM3187	3	3/16	1	18
STM3187-1	3	3/16	1-1/4	18
STM3218	3	7/32	1	18
STM3218-1	3	7/32	1-1/4	18
STM3250	3	1/4	1	18
STM3250-1	3	1/4	1-1/4	18
STM3281	3	9/32	1	18
STM3281-1	3	9/32	1-1/4	18
STM3312	3	5/16	1	18
STM3312-1	3	5/16	1-1/4	18
STM3343	3	11/32	1	18
STM3343-1	3	11/32	1-1/4	18
STM3375	3	3/8	1	18
STM3375-1	3	3/8	1-1/4	18
STM3406	3	13/32	1	18
STM3406-1	3	13/32	1-1/4	18
STM3437	3	7/16	1	18
STM3437-1	3	7/16	1-1/4	18
STM3500	3	1/2	1	18
STM3500-1	3	1/2	1-1/4	18
STM3562	3	9/16	1	18
STM3562-1	3	9/16	1-1/4	18
STM3625	3	5/8	1	18
STM3625-1	3	5/8	1-1/4	18
STM3687	3	11/16	1	18
STM3687-1	3	11/16	1-1/4	18
STM3750	3	3/4	1	18
STM3750-1	3	3/4	1-1/4	18
STM3812	3	13/16	1	18
STM3812-1	3	13/16	1-1/4	18
STM3875	3	7/8	1	18
STM3875-1	3	7/8	1-1/4	18

Catalog No.	Cutter Diam.	Width	Hole Size	No. of Teeth
STM3937	3	15/16	1	18
STM3937-1	3	15/16	1-1/4	18
STM3100	3	1	1	18
STM3100-1	3	1	1-1/4	18
STM31250	3	1-1/4	1	18
STM31250-1	3	1-1/4	1-1/4	18
STM35218	3-1/2	7/32	1	18
STM35218-1	3-1/2	7/32	1-1/4	18
STM35250	3-1/2	1/4	1	18
STM35250-1	3-1/2	1/4	1-1/4	18
STM35281	3-1/2	9/32	1	18
STM35281-1	3-1/2	9/32	1-1/4	18
STM35312	3-1/2	5/16	1	18
STM35312-1	3-1/2	5/16	1-1/4	18
STM35343	3-1/2	11/32	1	18
STM35343-1	3-1/2	11/32	1-1/4	18
STM35375	3-1/2	3/8	1	18
STM35375-1	3-1/2	3/8	1-1/4	18
STM35406	3-1/2	13/32	1	18
STM35406-1	3-1/2	13/32	1-1/4	18
STM35437	3-1/2	7/16	1	18
STM35437-1	3-1/2	7/16	1-1/4	18
STM35500	3-1/2	1/2	1	18
STM35500-1	3-1/2	1/2	1-1/4	18
STM35562	3-1/2	9/16	1	18
STM35562-1	3-1/2	9/16	1-1/4	18
STM35625	3-1/2	5/8	1	18
STM35625-1	3-1/2	5/8	1-1/4	18
STM35687	3-1/2	11/16	1	18
STM35687-1	3-1/2	11/16	1-1/4	18
STM35750	3-1/2	3/4	1	18
STM35750-1	3-1/2	3/4	1-1/4	18
STM35812	3-1/2	13/16	1	18
STM35812-1	3-1/2	13/16	1-1/4	18

Side Milling Cutters

Staggered Tooth (continued)

Catalog No.	Cutter Diam.	Width	Hole Size	No. of Teeth
STM35875	3-1/2	7/8	1	18
STM35875-1	3-1/2	7/8	1-1/4	18
STM35937	3-1/2	15/16	1	18
STM35937-1	3-1/2	15/16	1-1/4	18
STM35100	3-1/2	1	1	18
STM35100-1	3-1/2	1	1-1/4	18
STM4187	4	3/16	1	18
STM4187-1	4	3/16	1-1/4	18
STM4218	4	7/32	1	18
STM4218-1	4	7/32	1-1/4	18
STM4250	4	1/4	1	18
STM4250-1	4	1/4	1-1/4	18
STM4281	4	9/32	1	18
STM4281-1	4	9/32	1-1/4	18
STM4312	4	5/16	1	18
STM4312-1	4	5/16	1-1/4	18
STM4343	4	11/32	1	18
STM4343-1	4	11/32	1-1/4	18
STM4375	4	3/8	1	18
STM4375-1	4	3/8	1-1/4	18
STM4406	4	13/32	1	18
STM4406-1	4	13/32	1-1/4	18
STM4437	4	7/16	1	18
STM4437-1	4	7/16	1-1/4	18
STM4500	4	1/2	1	18
STM4500-1	4	1/2	1-1/4	18
STM4531	4	17/32	1	18
STM4562	4	9/16	1	18
STM4562-1	4	9/16	1-1/4	18
STM4625	4	5/8	1	18
STM4625-1	4	5/8	1-1/4	18
STM4687	4	11/16	1	18
STM4687-1	4	11/16	1-1/4	18
STM4750	4	3/4	1	18
STM4750-1	4	3/4	1-1/4	18
STM4812	4	13/16	1	18
STM4812-1	4	13/16	1-1/4	18
STM4875	4	7/8	1	18
STM4875-1	4	7/8	1-1/4	18
STM4937	4	15/16	1	18
STM4937-1	4	15/16	1-1/4	18
STM4100	4	1	1	18
STM4100-1	4	1	1-1/4	18
STM41125-1	4	1-1/8	1-1/4	18
STM41187-1	4	1-3/16	1-1/4	18
STM41250-1	4	1-1/4	1-1/4	18
STM41375-1	4	1-3/8	1-1/4	18
STM41500-1	4	1-1/2	1-1/4	18
STM45218-18T	4-1/2	7/32	1	18
STM45218-24T	4-1/2	7/32	1	24
STM45218-1-18T	4-1/2	7/32	1-1/4	18
STM45218-1-24T	4-1/2	7/32	1-1/4	24
STM45250-18T	4-1/2	1/4	1	18
STM45250-24T	4-1/2	1/4	1	24
STM45250-1-18T	4-1/2	1/4	1-1/4	18
STM45250-1-24T	4-1/2	1/4	1-1/4	24

Catalog No.	Cutter Diam.	Width	Hole Size	No. of Teeth
STM45312-18T	4-1/2	5/16	1	18
STM45312-24T	4-1/2	5/16	1	24
STM45312-1-18T	4-1/2	5/16	1-1/4	18
STM45312-1-24T	4-1/2	5/16	1-1/4	24
STM45375-18T	4-1/2	3/8	1	18
STM45375-24T	4-1/2	3/8	1	24
STM45375-1-18T	4-1/2	3/8	1-1/4	18
STM45375-1-24T	4-1/2	3/8	1-1/4	24
STM45500-18T	4-1/2	1/2	1	18
STM45500-24T	4-1/2	1/2	1	24
STM45500-1-18T	4-1/2	1/2	1-1/4	18
STM45500-1-24T	4-1/2	1/2	1-1/4	24
STM45625-18T	4-1/2	5/8	1	18
STM45625-24T	4-1/2	5/8	1	24
STM45625-1-18T	4-1/2	5/8	1-1/4	18
STM45625-1-24T	4-1/2	5/8	1-1/4	24
STM45687-1-24T	4-1/2	11/16	1-1/4	24
STM45750-18T	4-1/2	3/4	1	18
STM45750-24T	4-1/2	3/4	1	24
STM45750-1-18T	4-1/2	3/4	1-1/4	18
STM45750-1-24T	4-1/2	3/4	1-1/4	24
STM45875-18T	4-1/2	7/8	1	18
STM45875-24T	4-1/2	7/8	1	24
STM45875-1-18T	4-1/2	7/8	1-1/4	18
STM45875-1-24T	4-1/2	7/8	1-1/4	24
STM45100-18T	4-1/2	1	1	18
STM45100-24T	4-1/2	1	1	24
STM45100-1-18T	4-1/2	1	1-1/4	18
STM45100-1-24T	4-1/2	1	1-1/4	24
STM451250-18T	4-1/2	1-1/4	1	18
STM451250-24T	4-1/2	1-1/4	1	24
STM451250-1-18T	4-1/2	1-1/4	1-1/4	18
STM451250-1-24T	4-1/2	1-1/4	1-1/4	24
STM5187	5	3/16	1	24
STM5218	5	7/32	1	24
STM5218-1	5	7/32	1-1/4	24
STM5250	5	1/4	1	24
STM5250-1	5	1/4	1-1/4	24
STM5281	5	9/32	1	24
STM5281-1	5	9/32	1-1/4	24
STM5312	5	5/16	1	24
STM5312-1	5	5/16	1-1/4	24
STM5343	5	11/32	1	24
STM5343-1	5	11/32	1-1/4	24
STM5375	5	3/8	1	24
STM5375-1	5	3/8	1-1/4	24
STM5406	5	13/32	1	24
STM5406-1	5	13/32	1-1/4	24
STM5437	5	7/16	1	24
STM5437-1	5	7/16	1-1/4	24
STM5468	5	15/32	1	24
STM5468-1	5	15/32	1-1/4	24
STM5500	5	1/2	1	24
STM5500-1	5	1/2	1-1/4	24
STM5531-1	5	17/32	1-1/4	24
STM5562	5	9/16	1	24
STM5562-1	5	9/16	1-1/4	24

Side Milling Cutters

Staggered Tooth (continued)

Catalog No.	Cutter Diam.	Width	Hole Size	No. of Teeth
STM5593-1	5	19/32	1-1/4	24
STM5625	5	5/8	1	24
STM5625-1	5	5/8	1-1/4	24
STM5687	5	11/16	1	24
STM5687-1	5	11/16	1-1/4	24
STM5750	5	3/4	1	24
STM5750-1	5	3/4	1-1/4	24
STM5812	5	13/16	1	24
STM5812-1	5	13/16	1-1/4	24
STM5875	5	7/8	1	24
STM5875-1	5	7/8	1-1/4	24
STM5937-1	5	15/16	1-1/4	24
STM5100	5	1	1	24
STM5100-1	5	1	1-1/4	24
STM51250-1	5	1-1/4	1-1/4	24
STM51500-1	5	1-1/2	1-1/4	24
STM5187	5	3/16	1	24
STM55250	5-1/2	1/4	1	24
STM55250-1	5-1/2	1/4	1-1/4	24
STM55312	5-1/2	5/16	1	24
STM55312-1	5-1/2	5/16	1-1/4	24
STM55375	5-1/2	3/8	1	24
STM55375-1	5-1/2	3/8	1-1/4	24
STM55500	5-1/2	1/2	1	24
STM55500-1	5-1/2	1/2	1-1/4	24
STM55625	5-1/2	5/8	1	24
STM55625-1	5-1/2	5/8	1-1/4	24
STM55750	5-1/2	3/4	1	24
STM55750-1	5-1/2	3/4	1-1/4	24
STM55875	5-1/2	7/8	1	24
STM55875-1	5-1/2	7/8	1-1/4	24
STM55100	5-1/2	1	1	24
STM55100-1	5-1/2	1	1-1/4	24
STM551250	5-1/2	1-1/4	1	24
STM551250-1	5-1/2	1-1/4	1-1/4	24
STM6218	6	7/32	1	24
STM6218-1	6	7/32	1-1/4	24
STM6250	6	1/4	1	24
STM6250-1	6	1/4	1-1/4	24
STM6281	6	9/32	1	24
STM6281-1	6	9/32	1-1/4	24
STM6312	6	5/16	1	24
STM6312-1	6	5/16	1-1/4	24
STM6343	6	11/32	1	24
STM6343-1	6	11/32	1-1/4	24
STM6375	6	3/8	1	24
STM6375-1	6	3/8	1-1/4	24
STM6406	6	13/32	1	24
STM6406-1	6	13/32	1-1/4	24
STM6437	6	7/16	1	24
STM6437-1	6	7/16	1-1/4	24
STM6468	6	15/32	1	24
STM6468-1	6	15/32	1-1/4	24
STM6500	6	1/2	1	24
STM6500-1	6	1/2	1-1/4	24

For Cobalt
see page 12.



CORNER RADIUS-ALTERED WIDTH
ALL TOOLS IN THIS CATALOG
CAN BE ALTERED AND SHIPPED
IN LESS THAN 48 HOURS

Catalog No.	Cutter Diam.	Width	Hole Size	No. of Teeth
STM6531-1	6	17/32	1-1/4	24
STM6562	6	9/16	1	24
STM6562-1	6	9/16	1-1/4	24
STM6625	6	5/8	1	24
STM6625-1	6	5/8	1-1/4	24
STM6687	6	11/16	1	24
STM6687-1	6	11/16	1-1/4	24
STM6750	6	3/4	1	24
STM6750-1	6	3/4	1-1/4	24
STM6812	6	13/16	1	24
STM6812-1	6	13/16	1-1/4	24
STM6875	6	7/8	1	24
STM6875-1	6	7/8	1-1/4	24
STM6937	6	15/16	1	24
STM6937-1	6	15/16	1-1/4	24
STM6100	6	1	1	24
STM6100-1	6	1	1-1/4	24
STM61125-1	6	1-1/8	1-1/4	24
STM61187-1	6	1-3/16	1-1/4	24
STM61250-1	6	1-1/4	1-1/4	24
STM7375-1	7	3/8	1-1/4	24
STM7500-1	7	1/2	1-1/4	24
STM7562-1	7	9/16	1-1/4	24
STM7625-1	7	5/8	1-1/4	24
STM7750-1	7	3/4	1-1/4	24
STM7100-1	7	1	1-1/4	24
STM8250-1	8	1/4	1-1/4	28
STM8250-2	8	1/4	1-1/2	28
STM8312-1	8	5/16	1-1/4	28
STM8312-2	8	5/16	1-1/2	28
STM8375-1	8	3/8	1-1/4	28
STM8375-2	8	3/8	1-1/2	28
STM8437-2	8	7/16	1-1/2	28
STM8500-1	8	1/2	1-1/4	28
STM8500-2	8	1/2	1-1/2	28
STM8625-1	8	5/8	1-1/4	28
STM8625-2	8	5/8	1-1/2	28
STM8750-1	8	3/4	1-1/4	28
STM8750-2	8	3/4	1-1/2	28
STM8100-1	8	1	1-1/4	28
STM8100-2	8	1	1-1/2	28
STM81125-1	8	1-1/8	1-1/4	28

Cobalt Side Milling Cutters

See page 32 for Cobalt Slitting Saws.

Straight Tooth

Catalog No.	Cutter Diam.	Width	Hole Size	No. of Teeth
CSM3250	3	1/4	1	20
CSM3312	3	5/16	1	20
CSM3375	3	3/8	1	20
CSM3500	3	1/2	1	20
CSM4187	4	3/16	1	24
CSM4218	4	7/32	1	24
CSM4250	4	1/4	1	24
CSM4250-1	4	1/4	1-1/4	24
CSM4312	4	5/16	1	24
CSM4312-1	4	5/16	1-1/4	24
CSM4375	4	3/8	1	24
CSM4375-1	4	3/8	1-1/4	24
CSM4500	4	1/2	1	24
CSM4500-1	4	1/2	1-1/4	24
CSM4562	4	9/16	1	24
CSM4625	4	5/8	1	24
CSM4625-1	4	5/8	1-1/4	24
CSM4750	4	3/4	1	24
CSM4750-1	4	3/4	1-1/4	24
CSM5250	5	1/4	1	24
CSM6100-1	6	1	1-1/4	28
CSM6250-1	6	1/4	1-1/4	28
CSM6375-1	6	3/8	1-1/4	28
CSM6500	6	1/2	1	28
CSM6500-1	6	1/2	1-1/4	28
CSM6625-1	6	5/8	1-1/4	28
CSM6750-1	6	3/4	1-1/4	28



**CORNER RADIUS-ALTERED WIDTH
ALL TOOLS IN THIS CATALOG
CAN BE ALTERED AND SHIPPED
IN LESS THAN 48 HOURS**

Staggered Tooth

Catalog No.	Cutter Diam.	Width	Hole Size	No. of Teeth
CSTM3187	3	3/16	1	18
CSTM3218	3	7/32	1	18
CSTM3250	3	1/4	1	18
CSTM3250-1	3	1/4	1-1/4	18
CSTM3312	3	5/16	1	18
CSTM3375	3	3/8	1	18
CSTM3375-1	3	3/8	1-1/4	18
CSTM3500	3	1/2	1	18
CSTM3500-1	3	1/2	1-1/4	18
CSTM4187	4	3/16	1	18
CSTM4187-1	4	3/16	1-1/4	18
CSTM4218	4	7/32	1	18
CSTM4218-1	4	7/32	1-1/4	18
CSTM4250	4	1/4	1	18
CSTM4250-1	4	1/4	1-1/4	18
CSTM4312	4	5/16	1	18
CSTM4312-1	4	5/16	1-1/4	18
CSTM4375	4	3/8	1	18
CSTM4375-1	4	3/8	1-1/4	18
CSTM4437-1	4	7/16	1-1/4	18
CSTM4500-1	4	1/2	1-1/4	18
CSTM4625-1	4	5/8	1-1/4	18
CSTM4750-1	4	3/4	1-1/4	18
CSTM6100-1	6	1	1-1/4	24
CSTM6250-1	6	1/4	1-1/4	24
CSTM6312-1	6	5/16	1-1/4	24
CSTM6375-1	6	3/8	1-1/4	24
CSTM6500-1	6	1/2	1-1/4	24
CSTM6625-1	6	5/8	1-1/4	28
CSTM6750-1	6	3/4	1-1/4	24
CSTM6875-1	6	7/8	1-1/4	24



Full Radius see page 21.

Shell End Mills

High Speed Steel General Purpose - Right Hand and Left Hand

General Purpose



Right Hand Shown

Catalog No. Right Hand	Diam.	Width	Hole Size	No. of Teeth	Catalog No. Left Hand
SH1258R	1-1/4	1	1/2	8	SH1258L
SH158R	1-1/2	1-1/8	1/2	8	SH158L
SH1758R	1-3/4	1-1/4	3/4	8	SH1758L
SH210R	2	1-3/8	3/4	10	SH210L
SH22510R	2-1/4	1-1/2	1	10	SH22510L
SH2510R	2-1/2	1-5/8	1	10	SH2510L
SH27510R	2-3/4	1-5/8	1	10	SH27510L
SH312R	3	1-3/4	1-1/4	12	SH312L
SH3512R	3-1/2	1-7/8	1-1/4	12	SH3512L
SH414R	4	2-1/4	1-1/2	14	SH414L
SH4514R	4-1/2	2-1/4	1-1/2	14	SH4514L
SH516R	5	2-1/4	1-1/2	16	SH516L
SH616R	6	2-1/4	2	16	SH616L

High Speed Steel for Cutting Aluminum - Right Hand Only

Catalog No.	Diam.	Width	Hole Size	No. of Teeth
ASH1254	1-1/4	1	1/2	4
ASH1504	1-1/2	1-1/8	1/2	4
ASH204	2	1-3/8	3/4	4
ASH254	2-1/2	1-5/8	1	4
ASH306	3	1-3/4	1-1/4	6
ASH356	3-1/2	1-7/8	1-1/4	6
ASH406	4	2-1/4	1-1/2	6
ASH456	4-1/2	2-1/4	1-1/2	6
ASH508	5	2-1/4	1-1/2	8
ASH608	6	2-1/4	2	8

Aluminum



Cobalt - Right Hand Only

Catalog No.	Diam.	Width	Hole Size	No. of Teeth
CSH1258	1-1/4	1	1/2	8
CSH158	1-1/2	1-1/8	1/2	8
CSH1758	1-3/4	1-1/4	3/4	8
CSH210	2	1-3/8	3/4	10
CSH22510	2-1/4	1-1/2	1	10
CSH2510	2-1/2	1-5/8	1	10
CSH27510	2-3/4	1-5/8	1	10
CSH312	3	1-3/4	1-1/4	12
CSH3512	3-1/2	1-7/8	1-1/4	12
CSH414	4	2-1/4	1-1/2	14
CSH4514	4-1/2	2-1/4	1-1/2	14
CSH516	5	2-1/4	1-1/2	16
CSH616	6	2-1/4	2	16

Cobalt

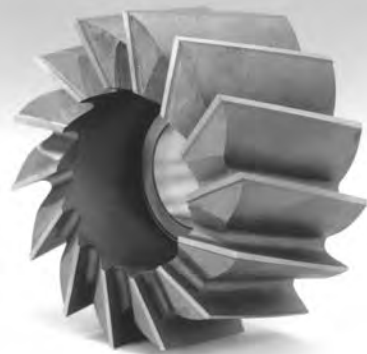

Carbide Tipped Side Milling Cutters

For Cast Iron



For Non-Ferrous Material

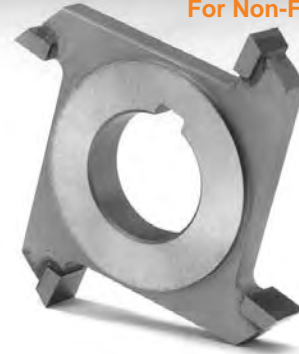

For Cast Iron

Catalog No.	Diam.	Width	Hole Size	No. of Teeth
CTSM3250-CL	3	1/4	1	6
CTSM3312-CL	3	5/6	1	6
CTSM3375-CL	3	3/8	1	6
CTSM3437-CL	3	7/16	1	6
CTSM3500-CL	3	1/2	1	6
CTSM4250-CL	4	1/4	1	8
CTSM4312-CL	4	5/16	1	8
CTSM4375-CL	4	3/8	1	8
CTSM4375-1-CL	4	3/8	1-1/4	8
CTSM4437-CL	4	7/16	1	8
CTSM4500-CL	4	1/2	1	8
CTSM4500-1-CL	4	1/2	1-1/4	8
CTSM4562-CL	4	9/16	1	8
CTSM4625-CL	4	5/8	1	8
CTSM4625-1-CL	4	5/8	1-1/4	8
CTSM4750-CL	4	3/4	1	8
CTSM4750-1-CL	4	3/4	1-1/4	8
CTSM5250-CL	5	1/4	1	10
CTSM5312-CL	5	5/16	1	10
CTSM5375-1-CL	5	3/8	1-1/4	10
CTSM5437-1-CL	5	7/16	1-1/4	10
CTSM5500-CL	5	1/2	1	10
CTSM5500-1-CL	5	1/2	1-1/4	10
CTSM5562-1-CL	5	9/16	1-1/4	10
CTSM5625-1-CL	5	5/8	1-1/4	10
CTSM5750-CL	5	3/4	1	10
CTSM5750-1-CL	5	3/4	1-1/4	10
CTSM5100-1-CL	5	1	1-1/4	10
CTSM6375-1-CL	6	3/8	1-1/4	12
CTSM6500-CL	6	1/2	1	12
CTSM6500-1-CL	6	1/2	1-1/4	12
CTSM6625-1-CL	6	5/8	1-1/4	12
CTSM6750-CL	6	3/4	1	12
CTSM6750-1-CL	6	3/4	1-1/4	12
CTSM6100-1-CL	6	1	1-1/4	12
CTSM8750-1-CL	8	3/4	1-1/4	12
CTSM8750-2-CL	8	3/4	1-1/2	12
CTSM8100-1-CL	8	1	1-1/4	12
CTSM8100-2-CL	8	1	1-1/2	12

For Non-Ferrous Material

Catalog No.	Diam.	Width	Hole Size	No. of Teeth
CTSM3250-NE	3	1/4	1	4
CTSM3312-NE	3	5/6	1	4
CTSM3375-NE	3	3/8	1	4
CTSM3437-NE	3	7/16	1	4
CTSM3500-NE	3	1/2	1	4
CTSM4250-NE	4	1/4	1	4
CTSM4312-NE	4	5/16	1	4
CTSM4375-NE	4	3/8	1	4
CTSM4375-1-NE	4	3/8	1-1/4	4
CTSM4437-NE	4	7/16	1	4
CTSM4500-NE	4	1/2	1	4
CTSM4500-1-NE	4	1/2	1-1/4	4
CTSM4562-NE	4	9/16	1	4
CTSM4625-NE	4	5/8	1	4
CTSM4625-1-NE	4	5/8	1-1/4	4
CTSM4750-NE	4	3/4	1	4
CTSM4750-1-NE	4	3/4	1-1/4	4
CTSM5250-NE	5	1/4	1	6
CTSM5312-NE	5	5/16	1	6
CTSM5437-1-NE	5	7/16	1-1/4	6
CTSM5500-NE	5	1/2	1	6
CTSM5500-1-NE	5	1/2	1-1/4	6
CTSM5562-1-NE	5	9/16	1-1/4	6
CTSM5625-1-NF	5	5/8	1-1/4	6
CTSM5750-NE	5	3/4	1	6
CTSM5750-1-NE	5	3/4	1-1/4	6
CTSM5100-1-NE	5	1	1-1/4	6
CTSM6375-NE	6	3/8	1	6
CTSM6375-1-NE	6	3/8	1-1/4	6
CTSM6500-NE	6	1/2	1	6
CTSM6500-1-NE	6	1/2	1-1/4	6
CTSM6625-1-NE	6	5/8	1-1/4	6
CTSM6750-NE	6	3/4	1	6
CTSM6750-1-NE	6	3/4	1-1/4	6
CTSM6100-1-NE	6	1	1-1/4	6
CTSM8750-1-NE	8	3/4	1-1/4	8
CTSM8750-2-NE	8	3/4	1-1/2	8
CTSM8100-1-NE	8	1	1-1/4	8
CTSM8100-2-NE	8	1	1-1/2	8

Carbide Tipped Side Milling Cutters

For Steel

Catalog No.	Diam.	Width	Hole Size	No. of Teeth
CTSM3250-S	3	1/4	1	6
CTSM3312-S	3	5/6	1	6
CTSM3375-S	3	3/8	1	6
CTSM3437-S	3	7/16	1	6
CTSM3500-S	3	1/2	1	6
CTSM4250-S	4	1/4	1	8
CTSM4312-S	4	5/16	1	8
CTSM4375-S	4	3/8	1	8
CTSM4375-1-S	4	3/8	1-1/4	8
CTSM4437-S	4	7/16	1	8
CTSM4500-S	4	1/2	1	8
CTSM4500-1-S	4	1/2	1-1/4	8
CTSM4562-S	4	9/16	1	8
CTSM4625-S	4	5/8	1	8
CTSM4625-1-S	4	5/8	1-1/4	8
CTSM4750-S	4	3/4	1	8
CTSM4750-1-S	4	3/4	1-1/4	8
CTSM5250-S	5	1/4	1	10
CTSM5312-S	5	5/16	1	10
CTSM5375-1-S	5	3/8	1-1/4	10
CTSM5437-1-S	5	7/16	1-1/4	10
CTSM5500-S	5	1/2	1	10
CTSM5500-1-S	5	1/2	1-1/4	10
CTSM5562-1-S	5	9/16	1-1/4	10
CTSM5625-1-S	5	5/8	1-1/4	10



Catalog No.	Diam.	Width	Hole Size	No. of Teeth
CTSM5750-S	5	3/4	1	10
CTSM5750-1-S	5	3/4	1-1/4	10
CTSM5100-1-S	5	1	1-1/4	10
CTSM6375-1-S	6	3/8	1-1/4	12
CTSM6500-S	6	1/2	1	12
CTSM6500-1-S	6	1/2	1-1/4	12
CTSM6625-1-S	6	5/8	1-1/4	12
CTSM6750-S	6	3/4	1	12
CTSM6750-1-S	6	3/4	1-1/4	12
CTSM6100-1-S	6	1	1-1/4	12
CTSM8750-1-S	8	3/4	1-1/4	12
CTSM8750-2-S	8	3/4	1-1/2	12
CTSM8100-1-S	8	1	1-1/4	12
CTSM8100-2-S	8	1	1-1/2	12

H.S.S. Combined Drills and Countersinks

H.S.S. Combined Drills and Countersinks

Catalog No.	Size	Body Diam.	Drill Diam.	Pkg. Qty.
CDC-0	0	1/8	1/32	6
CDC-1	1	1/8	3/64	6
CDC-2	2	3/16	5/64	6
CDC-3	3	1/4	7/64	6
CDC-4	4	5/16	1/8	3
CDC-45	4-1/2	3/8	9/64	1
CDC-5	5	7/16	3/16	1
CDC-6	6	1/2	7/32	1
CDC-7	7	5/8	1/4	1
CDC-8	8	3/4	5/16	1
CDC-11	11	1/8	3/64	6
CDC-12	12	3/16	1/16	6
CDC-13	13	1/4	3/32	6
CDC-14	14	5/16	7/64	3
CDC-15	15	7/16	5/32	1
CDC-16	16	1/2	3/16	1
CDC-17	17	5/8	7/32	1
CDC-18	18	3/4	1/4	1



Corner Rounding End Mills



Mfg. with Std. Weldon Flats

Corner Rounding End Mills

H.S.S.	Cobalt	Radius	Shank	Large Diam.	O.A.L.
CR032	CCR032	1/32	3/8	7/16	2-1/2
CR062	CCR062	1/16	3/8	7/16	2-1/2
CR093	CCR093	3/32	3/8	1/2	2-1/2
CR125	CCR125	1/8	1/2	5/8	3
CR156	CCR156	5/32	1/2	3/4	3
CR187	CCR187	3/16	1/2	7/8	2-15/16
CR187-1	CCR187-1	3/16	3/4	7/8	3-1/8
CR250	CCR250	1/4	1/2	1	3
CR250-1	CCR250-1	1/4	3/4	1	3-1/4
CR312	CCR312	5/16	3/4	1-1/8	3-1/4
CR312-1	CCR312-1	5/16	7/8	1-1/8	3-1/2
CR375	CCR375	3/8	3/4	1-1/4	3-1/2
CR375-1	CCR375-1	3/8	7/8	1-1/4	3-3/4
CR437	CCR437	7/16	3/4	1-3/8	3-3/4
CR437-1	CCR437-1	7/16	1	1-3/8	4
CR500	CCR500	1/2	3/4	1-1/2	3-7/8
CR500-1	CCR500-1	1/2	1	1-1/2	4-1/8
CR625	CCR625	5/8	3/4	1-15/16	4
CR625-1	CCR625-1	5/8	1	1-15/16	4-1/4
CR750	CCR750	3/4	5/8	2-1/4	4-1/8
CR750-1	CCR750-1	3/4	3/4	2-1/4	4-1/8
CR750-2	CCR750-2	3/4	1	2-1/4	4-5/16

Carbide Tipped	Radius	Shank	Large Diam.	O.A.L.
CTCR062	1/16	3/8	7/16	2-3/4
CTCR093	3/32	3/8	1/2	2-3/4
CTCR125	1/8	1/2	5/8	3
CTCR156	5/32	1/2	3/4	3
CTCR187-1	3/16	3/4	7/8	3-1/4
CTCR250-1	1/4	3/4	1	3-1/4
CTCR312-1	5/16	7/8	1-1/8	3-1/2
CTCR375-1	3/8	7/8	1-1/4	3-3/4
CTCR437-1	7/16	1	1-3/8	4
CTCR500-1	1/2	1	1-1/2	4
CTCR625-1	5/8	1-1/4	2	4-1/4

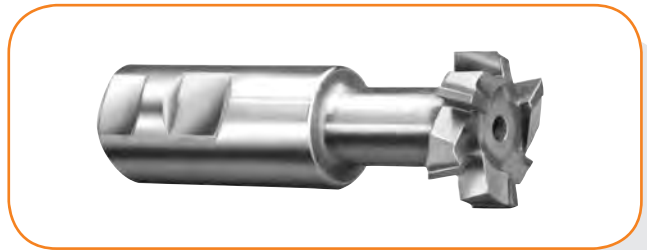

T-Slot Cutters – Carbide Tipped

Staggered Tooth

Straight Shank - Solid High Speed Steel, Cobalt and Carbide Tipped.
Right Hand cut standard with staggered teeth.
Excellent chip clearance.

Carbide Tipped	Bolt Size	Cutter Diam.	Cutter Width	Neck Diam.	O.A.L.	Shank Diam.	No. of Teeth
CTTS50	1/4	9/16	15/64	17/64	2-19/32	1/2	6
CTTS75	5/16	21/32	17/64	21/64	2-11/16	1/2	6
CTTS100	3/8	25/32	21/64	13/32	3-1/4	3/4	6
CTTS125	1/2	31/32	25/64	17/32	3-7/16	3/4	6
CTTS150	5/8	1-1/4	31/64	21/32	3-15/16	1	6
CTTS175	3/4	1-15/32	5/8	25/32	4-7/16	1	6
CTTS200	1	1-27/32	53/64	1-1/32	4-13/16	1-1/4	8
CTTS225	1-1/4	2-7/32	1-3/32	1-7/32	5-3/8	1-1/4	8
CTTS250	1-1/2	2-21/32	1-11/32	1-17/32	5-29/32	1-1/4	8

High Speed Steel and Cobalt see page 17.

T-Slot Cutters – H.S.S. and Cobalt

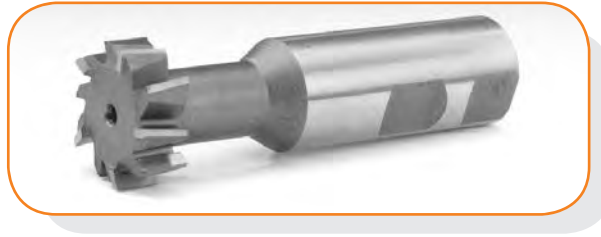

Staggered Tooth

Carbided Tipped see page 16.

Straight Shank - Solid High Speed Steel, Cobalt and Carbide Tipped. Right Hand cut standard with staggered teeth. Excellent chip clearance.

H.S.S.	Cobalt	Bolt Size	Cutter Diam.	Cutter Width	Neck Diam.	O.A.L.	Shank Diam.	No. of Teeth
TS50	CTS50	1/4	9/16	15/64	17/64	2-19/32	1/2	8
TS75	CTS75	5/16	21/32	17/64	21/64	2-11/16	1/2	8
TS100	CTS100	3/8	25/32	21/64	13/32	3-1/4	3/4	8
TS125	CTS125	1/2	31/32	25/64	17/32	3-7/16	3/4	8
TS150	CTS150	5/8	1-1/4	31/64	21/32	3-15/16	1	10
TS175	CTS175	3/4	1-15/32	5/8	25/32	4-7/16	1	10
TS200	CTS200	1	1-27/32	53/64	1-1/32	4-13/16	1-1/4	10
TS225	CTS225	1-1/4	2-7/32	1-3/32	1-7/32	5-3/8	1-1/4	10
TS250	CTS250	1-1/2	2-21/32	1-11/32	1-7/32	5-29/32	1-1/4	12

Extended Shank Slot Cutters – H.S.S. and Cobalt

H.S.S.	Cobalt	Head Dia. "O.D."	Head Width	Shank Dia.	Neck Dia. X Length	Overall Length	No of Teeth
FIS1-18	CFIS1-18	1	1/8	5/8	.437 X 1	4-15/16	8
FIS1-316	CFIS1-316	1	3/16	5/8	.437 X 1	4-15/16	8
FIS1-14	CFIS1-14	1	1/4	5/8	.437 X 1	4-15/16	8
FIS1-516	CFIS1-516	1	5/16	5/8	.437 X 1	4-15/16	8
FIS1-38	CFIS1-38	1	3/8	5/8	.437 X 1	4-15/16	8
FIS1-12	CFIS1-12	1	1/2	5/8	.437 X 1	4-15/16	8
FIS1-58	CFIS1-58	1	5/8	5/8	.437 X 1	4-15/16	8
FIS12-18	CFIS12-18	1-1/4	1/8	3/4	.593 X 1-1/8	5-1/8	8
FIS12-316	CFIS12-316	1-1/4	3/16	3/4	.593 X 1-1/8	5-1/8	8
FIS12-14	CFIS12-14	1-1/4	1/4	3/4	.593 X 1-1/8	5-1/8	8
FIS12-516	CFIS12-516	1-1/4	5/16	3/4	.593 X 1-1/8	5-1/8	8
FIS12-38	CFIS12-38	1-1/4	3/8	3/4	.593 X 1-1/8	5-1/8	8
FIS12-12	CFIS12-12	1-1/4	1/2	3/4	.593 X 1-1/8	5-1/8	8
FIS12-58	CFIS12-58	1-1/4	5/8	3/4	.593 X 1-1/8	5-1/8	8
FIS15-18	CFIS15-18	1-1/2	1/8	1	.718 X 1-11/32	5-5/16	8
FIS15-316	CFIS15-316	1-1/2	3/16	1	.718 X 1-11/32	5-5/16	8
FIS15-14	CFIS15-14	1-1/2	1/4	1	.718 X 1-11/32	5-5/16	8
FIS15-516	CFIS15-516	1-1/2	5/16	1	.718 X 1-11/32	5-5/16	8
FIS15-38	CFIS15-38	1-1/2	3/8	1	.718 X 1-11/32	5-5/16	8
FIS15-12	CFIS15-12	1-1/2	1/2	1	.718 X 1-11/32	5-5/16	8
FIS15-58	CFIS15-58	1-1/2	5/8	1	.718 X 1-11/32	5-5/16	8
FIS2-316	CFIS2-316	2	3/16	1	.796 X 1-9/16	5-11/16	10
FIS2-14	CFIS2-14	2	1/4	1	.796 X 1-9/16	5-11/16	10
FIS2-516	CFIS2-516	2	5/16	1	.796 X 1-9/16	5-11/16	10
FIS2-38	CFIS2-38	2	3/8	1	.796 X 1-9/16	5-11/16	10
FIS2-12	CFIS2-12	2	1/2	1	.796 X 1-9/16	5-11/16	10
FIS2-58	CFIS2-58	2	5/8	1	.796 X 1-9/16	5-11/16	10

Dovetail Cutters

H.S.S. / Cobalt



H.S.S.	Cobalt	Diam.	Width	Angle	O.A.L.	Shank	No. of Teeth
DT3758-45	CDT3758-45	3/8	1/8	45°	2-1/16	3/8	8
DT5008-45	CDT5008-45	1/2	1/8	45°	2-1/8	3/8	8
DT7508-45	CDT7508-45	3/4	7/32	45°	2-5/32	3/8	8
DT137510-45	CDT137510-45	1-3/8	3/8	45°	2-17/32	1/2	10
DT137512-45	CDT137512-45	1-3/8	3/8	45°	2-13/16	5/8	10
DT187512-45	CDT187512-45	1-7/8	1/2	45°	2-15/16	7/8	12
DT225012-45	CDT225012-45	2-1/4	11/16	45°	3-9/16	1	12
DT250012-45	CDT250012-45	2-1/2	3/4	45°	3-3/4	1	12
DT3758-60	CDT3758-60	3/8	3/16	60°	2-1/8	3/8	8
DT5008-60	CDT5008-60	1/2	7/32	60°	2-1/8	3/8	8
DT7508-60	CDT7508-60	3/4	5/16	60°	2-1/8	3/8	8
DT137512-60	CDT137512-60	1-3/8	9/16	60°	3	5/8	12
DT187512-60	CDT187512-60	1-7/8	13/16	60°	3-1/4	7/8	12
DT225012-60	CDT225012-60	2-1/4	1-1/16	60°	3-3/4	1	12
DT250012-60	CDT250012-60	2-1/2	1-1/8	60°	3-3/4	1	12

Carbide Tipped*

Carbide Tipped	Diam.	Width	Shank	O.A.L.
CTDT500-45	1/2	5/32	3/8	2-1/8
CTDT750-45	3/4	1/4	3/8	2-1/4
CTDT1000-45	1	5/16	1/2	2-1/2
CTDT1250-45	1-1/4	3/8	5/8	2-3/4
CTDT1500-45	1-1/2	1/2	3/4	3-1/4
CTDT2000-45	2	5/8	1	4-1/4
CTDT2500-45	2-1/2	3/4	1-1/4	4-3/8
CTDT3000-45	3	1	1-1/4	4-1/2
CTDT500-60	1/2	7/32	3/8	2-1/8
CTDT750-60	3/4	1/4	3/8	2-1/4
CTDT1000-60	1	3/8	1/2	2-1/2
CTDT1250-60	1-1/4	1/2	5/8	2-3/4
CTDT1500-60	1-1/2	5/8	3/4	3-1/4
CTDT2000-60	2	3/4	1	4-1/4
CTDT2500-60	2-1/2	7/8	1-1/4	4-3/8
CTDT3000-60	3	1-1/8	1-1/4	4-1/2



* Carbide tipped dovetails have a .015/020 radius on corner –
* H.S.S. and Cobalt have sharp corner.

Face Angle Chamfer Milling Cutters



H.S.S.	Cobalt	Large Cutting Dia. D1	Small Cutting Dia. D2	Cutter Width W1	Shank	O.A.L.	No. of Teeth
60 Degree Included Angle							
FAC750-60	CFAC750-60	3/4	5/16	17/32	5/8	2-3/32	8
FAC1000-60	CFAC1000-60	1	3/8	11/16	1/2	2-13/32	8
FAC1250-60	CFAC1250-60	1-1/4	1/2	25/32	5/8	2-21/32	10
FAC1625-60	CFAC1625-60	1-5/8	5/8	1-1/16	3/4	3-1/16	12
90 Degree Included Angle							
FAC750-90	CFAC750-90	3/4	5/16	3/8	3/8	1-15/16	8
FAC1000-90	CFAC1000-90	1	3/8	7/16	1/2	2-3/16	8
FAC1250-90	CFAC1250-90	1-1/4	1/2	17/32	5/8	2-13/32	10
FAC1625-90	CFAC1625-90	1-5/8	5/8	11/16	3/4	2-11/16	12

Double Angle Cutters

H.S.S.



Double Angle Cutters

H.S.S.	Carbide Tipped	Cutter Dia.	Cutter Width	O.A.L.	Shank Dia.
60 Degree Included Angle					
SDA312-60		5/16	7/64	2-3/8	3/8
SDA375-60		3/8	9/64	2-3/8	3/8
SDA500-60		1/2	5/32	2-3/8	3/8
SDA750-60	CTSDA750-60	3/4	3/16	2-3/8	3/8
SDA100-60	CTSDA100-60	1	5/16	2-27/32	1/2
SDA1375-60	CTSDA1375-60	1-3/8	7/16	3-7/32	5/8
SDA1500-60	CTSDA1500-60	1-1/2	1/2	3-3/8	5/8
SDA1875-60	CTSDA1875-60	1-7/8	5/8	3-25/32	3/4
SDA2250-60	CTSDA2250-60	2-1/4	3/4	4-5/32	7/8
90 Degree Included Angle					
SDA312-90		5/16	1/8	2-3/8	3/8
SDA375-90		3/8	5/32	2-3/8	3/8
SDA500-90		1/2	3/16	2-3/8	3/8
SDA750-90	CTSDA750-90	3/4	1/4	2-3/8	3/8
SDA100-90	CTSDA100-90	1	3/8	2-29/32	1/2
SDA1375-90	CTSDA1375-90	1-3/8	1/2	3-9/32	5/8
SDA1500-90	CTSDA1500-90	1-1/2	9/16	3-7/16	5/8
SDA1875-90	CTSDA1875-90	1-7/8	5/8	3-25/32	3/4
SDA2250-90	CTSDA2250-90	2-1/4	3/4	4-5/32	7/8

Carbide Tipped



Single Angle Chamfer Cutters



H.S.S.

H.S.S.	Cutter Dia.	Angle Width	O.A.L.	Shank Dia.
45 Degree Included Angle				
SAC250-45	1/4	3/32	2-1/8	3/8
SAC312-45	5/16	1/8	2-1/8	3/8
SAC375-45	3/8	5/32	2-1/8	3/8
SAC500-45	1/2	1/8	2-1/8	3/8
SAC750-45	3/4	3/16	2-1/8	3/8
SAC1000-45	1	5/16	2-1/2	1/2
SAC1500-45	1-1/2	1/2	2-3/4	3/4
60 Degree Included Angle				
SAC250-60	1/4	5/32	2-1/8	3/8
SAC312-60	5/16	7/32	2-1/8	3/8
SAC375-60	3/8	17/64	2-1/8	3/8
SAC500-60	1/2	7/32	2-1/8	3/8
SAC750-60	3/4	5/16	2-1/8	3/8
SAC1000-60	1	7/16	2-1/2	1/2
SAC1500-60	1-1/2	5/8	2-3/4	3/4

Carbide Tipped

Carbide Tipped	Cutter Dia.	Angle Width	O.A.L.	Shank Dia.
45 Degree Included Angle				
CTSAC500-45	1/2	1/8	2-1/8	3/8
CTSAC750-45	3/4	3/16	2-1/8	3/8
CTSAC1000-45	1	5/16	2-1/2	1/2
CTSAC1500-45	1-1/2	1/2	2-3/4	3/4
60 Degree Included Angle				
CTSAC500-60	1/2	7/32	2-1/8	3/8
CTSAC750-60	3/4	5/16	2-1/8	3/8
CTSAC1000-60	1	7/16	2-1/2	1/2
CTSAC1500-60	1-1/2	5/8	2-3/4	3/4

Angle Milling Cutters

Single Angle

Single Angle Cutters come in 45 and 60 Degree Included Angles. All cutters have 20 teeth.

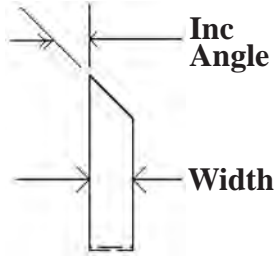

Catalog No. Right Hand	Catalog No. Left Hand	Diam.	Width	Hole Size	Inc. Angle
SA27500-R-45	SA27500-L-45	2-3/4	1/2	1	45
SA3500-R-45	SA3500-L-45	3	1/2	1-1/4	45
SA4500-R-45	SA4500-L-45	4	1/2	1-1/4	45
SA4750-R-45	SA4750-L-45	4	3/4	1-1/4	45
SA4100-R-45	SA4100-L-45	4	1	1-1/4	45
SA27500-R-60	SA27500-L-60	2-3/4	1/2	1	60
SA3500-R-60	SA3500-L-60	3	1/2	1-1/4	60
SA4500-R-60	SA4500-L-60	4	1/2	1-1/4	60
SA4750-R-60	SA4750-L-60	4	3/4	1-1/4	60
SA4100-R-60	SA4100-L-60	4	1	1-1/4	60



**CORNER RADIUS-ALTERED WIDTH
ALL TOOLS IN THIS CATALOG
CAN BE ALTERED AND SHIPPED
IN LESS THAN 48 HOURS**

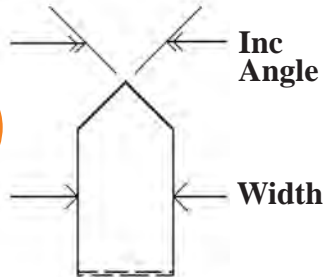

Double Angle

Double Angle Cutters come in 45, 60, and 90 Degree Included Angles. All cutters have 20 teeth.

Catalog No.	Diam.	Width	Hole Size	Inc Angle
DA27500-45	2-3/4	1/2	1	45
DA3500-45	3	1/2	1	45
DA4500-45	4	1/2	1-1/4	45
DA4750-45	4	3/4	1-1/4	45
DA27500-60	2-3/4	1/2	1	60
DA3500-60	3	1/2	1	60
DA4500-60	4	1/2	1-1/4	60
DA4750-60	4	3/4	1-1/4	60
DA4100-60	4	1	1-1/4	60
DA5750-60	5	3/4	1-1/4	60
DA5100-60	5	1	1-1/4	60
DA6100-60	6	1	1-1/4	60
DA61250-60	6	1-1/4	1-1/4	60
DA61500-60	6	1-1/2	1-1/4	60
DA27500-90	2 3/4	1/2	1	90
DA3500-90	3	1/2	1	90
DA4500-90	4	1/2	1-1/4	90
DA4750-90	4	3/4	1-1/4	90
DA4100-90	4	1	1-1/4	90
DA5750-90	5	3/4	1-1/4	90
DA5100-90	5	1	1-1/4	90
DA6100-90	6	1	1-1/4	90
DA61250-90	6	1-1/4	1-1/4	90
DA61500-90	6	1-1/2	1-1/4	90



Full Radius Side Milling Cutters

Cobalt Part #	H.S.S. Part #	Diam.	Width	Hole Size
BCSM3187	BSM3187	3	3/16	1
BCSM3187-1	BSM3187-1	3	3/16	1-1/4
BCSM3250	BSM3250	3	1/4	1
BCSM3250-1	BSM3250-1	3	1/4	1-1/4
BCSM3281	BSM3281	3	9/32	1
BCSM2181-1	BSM3281-1	3	9/32	1-1/4
BCSM3375	BSM3375	3	3/8	1
BCSM3375-1	BSM3375-1	3	3/8	1-1/4
BCSM3500	BSM3500	3	1/2	1
BCSM3500-1	BSM3500-1	3	1/2	1-1/4
BCSM4250	BSM4250	4	1/4	1
BCSM4250-1	BSM4250-1	4	1/4	1-1/4
BCSM4375	BSM4375	4	3/8	1
BCSM4375-1	BSM4375-1	4	3/8	1-1/4
BCSM4500	BSM4500	4	1/2	1
BCSM4500-1	BSM4500-1	4	1/2	1-1/4
BCSM4750-1	BSM4750-1	4	3/4	1-1/4
BCSM6250-1	BSM6250-1	6	1/4	1-1/4
BCSM6375-1	BSM6375-1	6	3/8	1-1/4
BCSM6437-1	BSM6437-1	6	7/16	1-1/4
BCSM6500-1	BSM6500-1	6	1/2	1-1/4

Straight Tooth



Cobalt Part #	H.S.S. Part #	Diam.	Width	Hole Size
BCSTM3187	BSTM3187	3	3/16	1
BCSTM3187-1	BSTM3187-1	3	3/16	1-1/4
BCSTM3250	BSTM3250	3	1/4	1
BCSTM3250-1	BSTM3250-1	3	1/4	1-1/4
BCSTM3281	BSTM3281	3	9/32	1
BCSTM3281-1	BSTM3281-1	3	9/32	1-1/4
BCSTM3375	BSTM3375	3	3/8	1
BCSTM3375-1	BSTM3375-1	3	3/8	1-1/4
BCSTM3500	BSTM3500	3	1/2	1
BCSTM3500-1	BSTM3500-1	3	1/2	1-1/4
BCSTM4250	BSTM4250	4	1/4	1
BCSTM4250-1	BSTM4250-1	4	1/4	1-1/4
BCSTM4375	BSTM4375	4	3/8	1
BCSTM4375-1	BSTM4375-1	4	3/8	1-1/4
BCSTM4500-1	BSTM4500-1	4	1/2	1-1/4
BCSTM6250-1	BSTM6250-1	6	1/4	1-1/4
BCSTM6375-1	BSTM6375-1	6	3/8	1-1/4
BCSTM6500-1	BSTM6500-1	6	1/2	1-1/4

Staggered Tooth



Full Radius Slitting Saws

Straight Tooth Slitting Saw



Cobalt Part #	H.S.S. Part #	Diam. x Width	Hole Size	Cobalt Part #	H.S.S. Part #	Diam. x Width	Hole Size
BCSS25125	BSS25125	2 1/2 x 1/8	7/8	BCSS4156	BSS4156	4 x 5/32	1
BCSS362	BSS362	3 x 1/16	1	BCSS4156-1	BSS4156-1	4 x 5/32	1-1/4
BCSS393	BSS393	3 x 3/32	1	BCSS4187	BSS4187	4 x 3/16	1
BCSS3125	BSS3125	3 x 1/8	1	BCSS4187-1	BSS4187-1	4 x 3/16	1-1/4
BCSS3156	BSS3156	3 x 5/32	1	BCSS4250	BSS4250	4 x 1/4	1
BCSS3187	BSS3187	3 x 3/16	1	BCSS4250-1	BSS4250-1	4 x 1/4	1-1/4
BCSS3250	BSS3250	3 x 1/4	1	BCSS6125	BSS6125	6 x 1/8	1
BCSS462	BSS462	4 x 1/16	1	BCSS6125-1	BSS6125-1	6 x 1/8	1 1/4
BCSS462-1	BSS462-1	4 x 1/16	1 1/4	BCSS6156	BSS6156	6 x 5/32	1
BCSS493	BSS493	4 x 3/32	1	BCSS6156-1	BSS6156-1	6 x 5/32	1 1/4
BCSS493-1	BSS493-1	4 x 3/32	1 1/4	BCSS6187	BSS6187	6 x 3/16	1
BCSS4125	BSS4125	4 x 1/8	1	BCSS6187-1	BSS6187-1	6 x 3/16	1 1/4
BCSS4125-1	BSS4125-1	4 x 1/8	1 1/4	BCSS6250	BSS6250	6 x 1/4	1
				BCSS6250-1	BSS6250-1	6 x 1/4	1-1/4

Woodruff Keyseat Cutters

Straight Tooth



Solid Carbide

CORNER RADIUS-ALTERED WIDTH
ALL TOOLS IN THIS CATALOG
CAN BE ALTERED AND SHIPPED
IN LESS THAN 48 HOURS

Staggered Tooth



Straight Tooth



H.S.S.
and Cobalt

Staggered Tooth



Straight Tooth



Carbide Tipped
1/2" shanks –
Right Hand cut;
chip breakers on
all tools 5/32" wide
and greater.

• Strong, one-piece construction on all keyseat cutters •

For narrow width sizes, see page 23.

Sizes 1/2" shank, rh cut			Straight Tooth				Staggered Tooth		
American Standard	Diam.	Width	Solid Carbide Part #	H.S.S. Part #	Cobalt Part #	Carbide Tipped	H.S.S. Part #	Cobalt Part #	Carbide Tipped
202	1/4	1/16	SC202	KY200	CKY200	-	STKY200	CSTKY200	-
202-1/2	5/16	1/16	-	KY225	CKY225	-	STKY225	CSTKY225	-
302-1/2	5/16	3/32	-	KY250	CKY250	-	STKY250	CSTKY250	-
203	3/8	1/16	SC203	KY275	CKY275	-	STKY275	CSTKY275	-
303	3/8	3/32	SC303	KY300	CKY300	-	STKY300	CSTKY300	-
403	3/8	1/8	SC403	KY325	CKY325	-	STKY325	CSTKY325	-
204	1/2	1/16	SC204	KY350	CKY350	TC204	STKY350	CSTKY350	STC204
304	1/2	3/32	SC304	KY375	CKY375	TC304	STKY375	CSTKY375	STC304
305	5/8	3/32	SC305	KY400	CKY400	TC305	STKY400	CSTKY400	STC305
404	1/2	1/8	SC404	KY425	CKY425	TC404	STKY425	CSTKY425	STC404
405	5/8	1/8	SC405	KY450	CKY450	TC405	STKY450	CSTKY450	STC405
406	3/4	1/8	SC406	KY475	CKY475	TC406	STKY475	CSTKY475	STC406
505	5/8	5/32	SC505	KY500	CKY500	TC505	STKY500	CSTKY500	STC505
605	5/8	3/16	SC605	KY525	CKY525	TC605	STKY525	CSTKY525	STC605
506	3/4	5/32	SC506	KY575	CKY575	TC506	STKY575	CSTKY575	STC506
806	3/4	1/4	SC806	KY600	CKY600	TC806	STKY600	CSTKY600	STC806
507	7/8	5/32	SC507	KY625	CKY625	TC507	STKY625	CSTKY625	STC507
606	3/4	3/16	SC606	KY650	CKY650	TC606	STKY650	CSTKY650	STC606
607	7/8	3/16	SC607	KY675	CKY675	TC607	STKY675	CSTKY675	STC607
707	7/8	7/32	SC707	KY700	CKY700	TC707	STKY700	CSTKY700	STC707
608	1	3/16	SC608	KY725	CKY725	TC608	STKY725	CSTKY725	STC608
708	1	7/32	SC708	KY750	CKY750	TC708	STKY750	CSTKY750	STC708
1208	1	3/8	SC1208	KY775	CKY775	TC1208	STKY775	CSTKY775	STC1208
609	1-1/8	3/16	SC609	KY800	CKY800	TC609	STKY800	CSTKY800	STC609
807	7/8	1/4	SC807	KY825	CKY825	TC807	STKY825	CSTKY825	STC807
808	1	1/4	SC808	KY850	CKY850	TC808	STKY850	CSTKY850	STC808
709	1-1/8	7/32	SC709	KY875	CKY875	TC709	STKY875	CSTKY875	STC709
809	1-1/8	1/4	SC809	KY900	CKY900	TC809	STKY900	CSTKY900	STC809
610	1-1/4	3/16	SC610	KY925	CKY925	TC610	STKY925	CSTKY925	STC610
710	1-1/4	7/32	SC710	KY950	CKY950	TC710	STKY950	CSTKY950	STC710
810	1-1/4	1/4	SC810	KY975	CKY975	TC810	STKY975	CSTKY975	STC810
811	1-3/8	1/4	-	KY1000	CKY1000	TC811	STKY1000	CSTKY1000	STC811
812	1-1/2	1/4	SC812	KY1025	CKY1025	TC812	STKY1025	CSTKY1025	STC812
1008	1	5/16	SC1008	KY1050	CKY1050	TC1008	STKY1050	CSTKY1050	STC1008
1009	1-1/8	5/16	SC1009	KY1075	CKY1075	TC1009	STKY1075	CSTKY1075	STC1009
1010	1-1/4	5/16	SC1010	KY1080	CKY1080	TC1010	STKY1080	CSTKY1080	STC1010
1011	1-3/8	5/16	-	KY1100	CKY1100	TC1011	STKY1100	CSTKY1100	STC1011
1012	1-1/2	5/16	SC1012	KY1125	CKY1125	TC1012	STKY1125	CSTKY1125	STC1012
1210	1-1/4	3/8	SC1012	KY1150	CKY1150	TC1210	STKY1150	CSTKY1150	STC1210
1211	1-3/8	3/8	-	KY1175	CKY1175	TC1211	STKY1175	CSTKY1175	STC1211
1212	1-1/2	3/8	SC1212	KY1200	CKY1200	TC1212	STKY1200	CSTKY1200	STC1212

Woodruff Keyseat Cutters – Narrow Width

CORNER RADIUS-ALTERED WIDTH
ALL TOOLS IN THIS CATALOG
CAN BE ALTERED AND SHIPPED
IN LESS THAN 48 HOURS



1/2" Shank - Right Hand Cut

Made from solid high speed steel and cobalt – straight tooth.
One piece construction. Specials quoted on request.

H.S.S. Part #	Diam. x Width	Cobalt Part #	H.S.S. Part #	Diam. x Width	Cobalt Part #	H.S.S. Part #	Diam. x Width	Cobalt Part #
NWKY25-164	1/4 x 1/64	CNWKY25-164	NWKY87-564	7/8 x 5/64	CNWKY87-564	NWKY12-764	1-1/4 x 7/64	CNWKY12-764
NWKY25-132	1/4 x 1/32	CNWKY25-132	NWKY87-332	7/8 x 3/32	CNWKY87-332	NWKY12-18	1-1/4 x 1/8	CNWKY12-18
NWKY25-364	1/4 x 3/64	CNWKY25-364	NWKY87-764	7/8 x 7/64	CNWKY87-764	NWKY12-964	1-1/4 x 9/64	CNWKY12-964
NWKY31-164	5/16 x 1/64	CNWKY31-164	NWKY87-18	7/8 x 1/8	CNWKY87-18	NWKY12-532	1-1/4 x 5/32	CNWKY12-532
NWKY31-132	5/16 x 1/32	CNWKY31-132	NWKY87-964	7/8 x 9/64	CNWKY87-964	NWKY12-1164	1-1/4 x 11/64	CNWKY12-1164
NWKY31-364	5/16 x 3/64	CNWKY31-364	NWKY1-364	1 x 3/64	CNWKY1-364	NWKY12-316	1-1/4 x 3/16	CNWKY12-316
NWKY37-164	3/8 x 1/64	CNWKY37-164	NWKY1-116	1 x 1/16	CNWKY1-116	NWKY12-732	1-1/4 x 7/32	CNWKY12-732
NWKY37-132	3/8 x 1/32	CNWKY37-132	NWKY1-564	1 x 5/64	CNWKY1-564	NWKY137-116	1-3/8 x 1/16	CNWKY137-116
NWKY37-364	3/8 x 3/64	CNWKY37-364	NWKY1-332	1 x 3/32	CNWKY1-332	NWKY137-564	1-3/8 x 5/64	CNWKY137-564
NWKY50-164	1/2 x 1/64	CNWKY50-164	NWKY1-764	1 x 7/64	CNWKY1-764	NWKY137-332	1-3/8 x 3/32	CNWKY137-332
NWKY50-020	1/2 x .020	CNWKY50-020	NWKY1-18	1 x 1/8	CNWKY1-18	NWKY137-764	1-3/8 x 7/64	CNWKY137-764
NWKY50-132	1/2 x 1/32	CNWKY50-132	NWKY1-964	1 x 9/64	CNWKY1-964	NWKY137-18	1-3/8 x 1/8	CNWKY137-18
NWKY50-364	1/2 x 3/64	CNWKY50-364	NWKY1-532	1 x 5/32	CNWKY1-532	NWKY137-964	1-3/8 x 9/64	CNWKY137-964
NWKY62-164	5/8 x 1/64	CNWKY62-164	NWKY1-1164	1 x 11/64	CNWKY1-1164	NWKY137-532	1-3/8 x 5/32	CNWKY137-532
NWKY62-020	5/8 x .020	CNWKY62-020	NWKY11-364	1-1/8 x 3/64	CNWKY11-364	NWKY137-1164	1-3/8 x 11/64	CNWKY137-1164
NWKY62-132	5/8 x 1/32	CNWKY62-132	NWKY11-116	1-1/8 x 1/16	CNWKY11-116	NWKY137-316	1-3/8 x 3/16	CNWKY137-316
NWKY62-364	5/8 x 3/64	CNWKY62-364	NWKY11-564	1-1/8 x 5/64	CNWKY11-564	NWKY137-732	1-3/8 x 7/32	CNWKY137-732
NWKY62-116	5/8 x 1/16	CNWKY62-116	NWKY11-332	1-1/8 x 3/32	CNWKY11-332	NWKY15-116	1-1/2 x 1/16	CNWKY15-116
NWKY62-564	5/8 x 5/64	CNWKY62-564	NWKY11-764	1-1/8 x 7/64	CNWKY11-764	NWKY15-564	1-1/2 x 5/64	CNWKY15-564
NWKY75-132	3/4 x 1/32	CNWKY75-132	NWKY11-18	1-1/8 x 1/8	CNWKY11-18	NWKY15-332	1-1/2 x 3/32	CNWKY15-332
NWKY75-364	3/4 x 3/64	CNWKY75-364	NWKY11-964	1-1/8 x 9/64	CNWKY11-964	NWKY15-764	1-1/2 x 7/64	CNWKY15-764
NWKY75-116	3/4 x 1/16	CNWKY75-116	NWKY11-532	1-1/8 x 5/32	CNWKY11-532	NWKY15-18	1-1/2 x 1/8	CNWKY15-18
NWKY75-564	3/4 x 5/64	CNWKY75-564	NWKY11-1164	1-1/8 x 11/64	CNWKY11-1164	NWKY15-964	1-1/2 x 9/64	CNWKY15-964
NWKY75-332	3/4 x 3/32	CNWKY75-332	NWKY12-364	1-1/4 x 3/64	CNWKY12-364	NWKY15-532	1-1/2 x 5/32	CNWKY15-532
NWKY75-764	3/4 x 7/64	CNWKY75-764	NWKY12-116	1-1/4 x 1/16	CNWKY12-116	NWKY15-1164	1-1/2 x 11/64	CNWKY15-1164
NWKY87-364	7/8 x 3/64	CNWKY87-364	NWKY12-564	1-1/4 x 5/64	CNWKY12-564	NWKY15-316	1-1/2 x 3/16	CNWKY15-316
NWKY87-116	7/8 x 1/16	CNWKY87-116	NWKY12-332	1-1/4 x 3/32	CNWKY12-332	NWKY15-732	1-1/2 x 7/32	CNWKY15-732

TiN coating Price On Application

Full Radius Keyseat Cutters

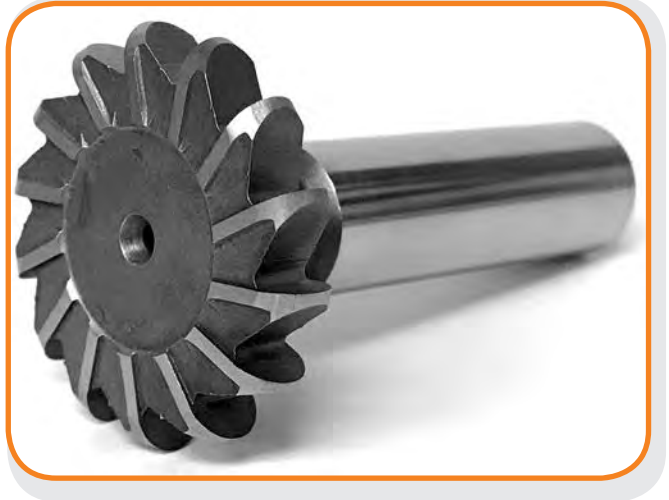

Full Profile Ground Radius

Made from solid high speed steel and cobalt – straight tooth.
One piece construction. Specials quoted on request.

*Wider sizes mfg with side gash for grinding and chip removal.

H.S.S.	COBALT	SIDE GASH	DIA	WIDTH	SHANK	RADIUS
BKY75-116	CBKY75-116		3/4	1/16	1/2	1/32
BKY75-18	CBKY75-18		3/4	1/8	1/2	1/16
BKY75-14	CBKY75-14	*	3/4	1/4	1/2	1/8
BKY87-116	CBKY87-116		7/8	1/16	1/2	1/32
BKY87-18	CBKY87-18		7/8	1/8	1/2	1/16
BKY87-14	CBKY87-14	*	7/8	1/4	1/2	1/8
BKY1-116	CBKY1-116		1	1/16	1/2	1/32
BKY1-18	CBKY1-18		1	1/8	1/2	1/16
BKY1-14	CBKY1-14	*	1	1/4	1/2	1/8
BKY1-38	CBKY1-38	*	1	3/8	1/2	3/16
BKY11-116	CBKY11-116		1-1/8	1/16	1/2	1/32
BKY11-18	CBKY11-18		1-1/8	1/8	1/2	1/16
BKY11-14	CBKY11-14		1-1/8	1/4	1/2	1/8
BKY11-38	CBKY11-38		1-1/8	3/8	1/2	3/16
BKY12-116	CBKY12-116		1 1/4	1/16	1/2	1/32
BKY12-18	CBKY12-18		1 1/4	1/8	1/2	1/16
BKY12-14	CBKY12-14	*	1 1/4	1/4	1/2	1/8
BKY12-38	CBKY12-38	*	1 1/4	3/8	1/2	3/16
BKY15-116	CBKY15-116		1 1/2	1/16	1/2	1/32
BKY15-18	CBKY15-18		1 1/2	1/8	1/2	1/16
BKY15-14	CBKY15-14	*	1 1/2	1/4	1/2	1/8
BKY15-38	CBKY15-38	*	1 1/2	3/8	1/2	3/16
BKY16-18	CBKY16-18		1 5/8	1/8	1/2	1/16
BKY16-14	CBKY16-14	*	1 5/8	1/4	1/2	1/8
BKY16-38	CBKY16-38	*	1 5/8	3/8	1/2	3/16
BKY16-12	CBKY16-12	*	1 5/8	1/2	1/2	1/4
BKY17-18	CBKY17-18		1 3/4	1/8	1/2	1/16
BKY17-14	CBKY17-14	*	1 3/4	1/4	1/2	1/8
BKY17-38	CBKY17-38	*	1 3/4	3/8	1/2	3/16
BKY17-12	CBKY17-12	*	1 3/4	1/2	1/2	1/4
BKY18-18	CBKY18-18		1 7/8	1/8	1/2	1/16
BKY18-14	CBKY18-14	*	1 7/8	1/4	1/2	1/8
BKY18-38	CBKY18-38	*	1 7/8	3/8	1/2	3/16
BKY18-12	CBKY18-12	*	1 7/8	1/2	1/2	1/4
BKY2-18	CBKY2-18		2	1/8	1/2	1/16
BKY2-14	CBKY2-14	*	2	1/4	1/2	1/8
BKY2-38	CBKY2-38	*	2	3/8	1/2	3/16
BKY2-12	CBKY2-12	*	2	1/2	1/2	1/4

Large Diameter Keyseat Cutters

H.S.S	Diam. x Width	Shank	Cobalt Part #
LDKY16-18	1-5/8 x 1/8	1/2	CLDKY16-18
LDKY16-316	1-5/8 x 3/16	1/2	CLDKY16-316
LDKY16-14	1-5/8 x 1/4	1/2	CLDKY16-14
LDKY16-516	1-5/8 x 5/16	1/2	CLDKY16-516
LDKY16-38	1-5/8 x 3/8	1/2	CLDKY16-38
LDKY16-12	1-5/8 x 1/2	1/2	CLDKY16-12
LDKY17-18	1-3/4 x 1/8	1/2	CLDKY17-18
LDKY17-316	1-3/4 x 3/16	1/2	CLDKY17-316
LDKY17-14	1-3/4 x 1/4	1/2	CLDKY17-14
LDKY17-516	1-3/4 x 5/16	1/2	CLDKY17-516
LDKY17-38	1-3/4 x 3/8	1/2	CLDKY17-38
LDKY17-12	1-3/4 x 1/2	1/2	CLDKY17-12
LDKY18-18	1-7/8 x 1/8	1/2	CLDKY18-18
LDKY18-316	1-7/8 x 3/16	1/2	CLDKY18-316
LDKY18-14	1-7/8 x 1/4	1/2	CLDKY18-14
LDKY18-516	1-7/8 x 5/16	1/2	CLDKY18-516
LDKY18-38	1-7/8 x 3/8	1/2	CLDKY18-38
LDKY18-12	1-7/8 x 1/2	1/2	CLDKY18-12
LDKY2-18	2 x 1/8	1/2	CLDKY2-18
LDKY2-316	2 x 3/16	1/2	CLDKY2-316
LDKY2-14	2 x 1/4	1/2	CLDKY2-14
LDKY2-516	2 x 5/16	1/2	CLDKY2-516
LDKY2-38	2 x 3/8	1/2	CLDKY2-38
LDKY2-12	2 x 1/2	1/2	CLDKY2-12

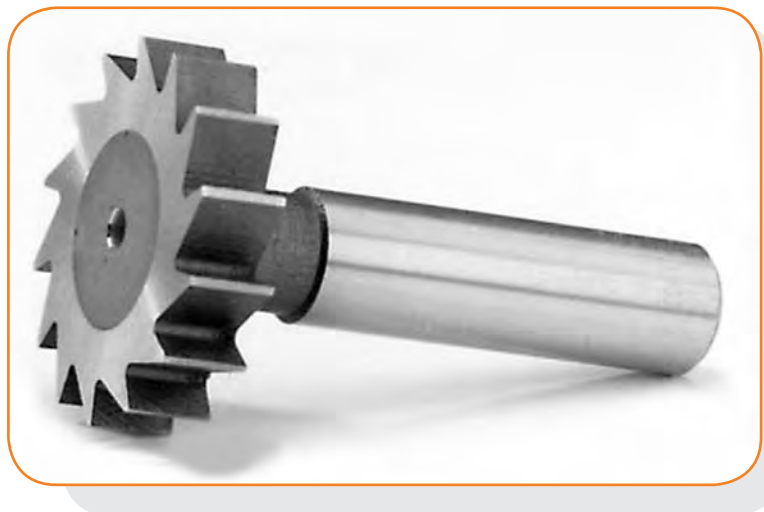

Mfg. with Std. Weldon Flats

Made from solid high speed steel and cobalt – straight tooth.
One piece construction. Specials quoted on request.
See page 33 for specials.

Concave Radius Milling Cutters Profile Ground



H.S.S.	Cobalt	Carbide Tipped	Radius	Cutter Dia.	Cutter Width	Shank Dia.	O.A.L.
CC750-132	COCC750-132	CTCC750-132	1/32	3/4	3/8	1/2	3
CC750-116	COCC750-116	CTCC750-116	1/16	3/4	3/8	1/2	3
CC875-332	COCC875-332	CTCC875-332	3/32	7/8	1/2	1/2	3
CC1250-18	COCC1250-18	CTCC1250-18	1/8	1-1/4	9/16	3/4	3-1/2
CC1312-532	COCC1312-532	CTCC1312-532	5/32	1-5/16	5/8	3/4	3-1/2
CC1375-316	COCC1375-316	CTCC1375-316	3/16	1-3/8	3/4	3/4	3-1/2
CC1500-14	COCC1500-14	CTCC1500-14	1/4	1-1/2	1	3/4	4
CC1750-516	COCC1750-516	CTCC1750-516	5/16	1-3/4	1-1/8	3/4	4
CC1875-38	COCC1875-38	CTCC1875-38	3/8	1-7/8	1-1/4	3/4	4

Convex Radius Milling Cutters Profile Ground

H.S.S.	Cobalt	Carbide Tipped	Radius	Cutter Dia.	Cutter Width	Shank Dia.	O.A.L.
CV750-132	CCV750-132	CTCV750-132	1/32	3/4	1/16	1/2	3
CV750-116	CCV750-116	CTCV750-116	1/16	3/4	1/8	1/2	3
CV875-332	CCV875-332	CTCV875-332	3/32	7/8	3/16	1/2	3
CV1250-18	CCV1250-18	CTCV1250-18	1/8	1-1/4	1/4	3/4	3-1/2
CV1312-532	CCV1312-532	CTCV1312-532	5/32	1-5/16	5/16	3/4	3-1/2
CV1375-316	CCV1375-316	CTCV1375-316	3/16	1-3/8	3/8	3/4	3-1/2
CV1500-14	CCV1500-14	CTCV1500-14	1/4	1-1/2	1/2	3/4	4
CV1750-516	CCV1750-516		5/16	1-3/4	5/8	3/4	4
CV1875-38	CCV1875-38		3/8	1-7/8	3/4	3/4	4



Woodruff Keysat Cutters



10 Piece Set Includes:

- 1 - #204 1 - #606
- 1 - #304 1 - #806
- 1 - #305 1 - #608
- 1 - #605 1 - #404
- 1 - #406 1 - #405



Available in 41 and 10 piece sets.

Catalog No.	41 Piece Set
KY set	STR.T.HSS - full set
STKY set	STG.T.HSS - full set
CKY set	STR.T.Cobalt - full set
CSTKY set	STG.T.Cobalt - full set

Catalog No.	10 Piece Set
KY - 10 pack	STR.T.HSS - 10 pc set
STKY - 10 pack	STG.T.HSS - 10 pc set
CKY - 10 pack	STR.T.Cobalt - 10 pc set
CSTKY - 10 pack	STG.T.Cobalt - 10 pc set

Arbor Type

All staggered tooth cutters with the same amount of teeth can be interlocked by grinding hubs.

These cutters are 1/32" larger in diameter than the normal size to allow for resharpening.

Catalog No.	Old Std.	Cutter Diam.	Width	Hole Size	No. of Teeth
K100	26	2-1/8	3/16	3/4	14
K102	27	2-1/8	1/4	3/4	14
K104	28	2-1/8	5/16	3/4	14
K106	29	2-1/8	3/8	3/4	14
K108	R	2-3/4	1/4	1	18
K110	S	2-3/4	5/16	1	18
K112	T	2-3/4	3/8	1	18
K114	U	2-3/4	7/16	1	18
K116	V	2-3/4	1/2	1	18
K118	30	3-1/2	3/8	1	18
K120	31	3-1/2	7/16	1	18
K122	32	3-1/2	1/2	1	18
K124	33	3-1/2	9/16	1	18
K126	34	3-1/2	5/8	1	18
K128	35	3-1/2	11/16	1	18
K130	36	3-1/2	3/4	1	18



Plain Milling Cutters

CORNER RADIUS-ALTERED WIDTH
ALL TOOLS IN THIS CATALOG
CAN BE ALTERED AND SHIPPED
IN LESS THAN 48 HOURS

Light Duty

Used for light milling or finish cuts.
Cutters less than 3/4" width have straight teeth. Cut-
ters 3/4" wide and over have spiral teeth.
Cutters come with Left Hand spiral, Right Hand cut.

Catalog No.	Cutter Diam.	Width	Hole Size	No. of Teeth
PI2510	2-1/2	3/16	1	18
PI2520	2-1/2	1/4	1	18
PI2530	2-1/2	5/16	1	18
PI2540	2-1/2	3/8	1	18
PI2550	2-1/2	7/16	1	18
PI2560	2-1/2	1/2	1	18
PI2570	2-1/2	5/8	1	18
PI2585	2-1/2	3/4	1	14
PI2595	2-1/2	1	1	14
PI25105	2-1/2	1-1/2	1	14
PI25115	2-1/2	2	1	14
PI25125	2-1/2	2-1/2	1	14
PI25135	2-1/2	3	1	14
PI305	3	3/16	1	18
PI315	3	1/4	1	18
PI325	3	5/16	1	18
PI335	3	3/8	1	18
PI345	3	7/16	1	18
PI355	3	1/2	1	18
PI365	3	5/8	1	18
PI375	3	3/4	1-1/4	16
PI385	3	7/8	1-1/4	16
PI395	3	1	1-1/4	16
PI3100	3	1-1/4	1-1/4	16
PI3110	3	1-1/2	1-1/4	16
PI3120	3	2	1-1/4	16
PI3130	3	2-1/2	1-1/4	16
PI3140	3	3	1-1/4	16
PI410	4	1/4	1	24
PI420	4	5/16	1	24
PI430	4	3/8	1	24
PI440	4	1/2	1-1/4	24
PI450	4	5/8	1-1/4	24
PI455	4	3/4	1-1/4	20
PI460	4	1	1-1/4	20
PI465	4	1-1/2	1-1/4	20
PI470	4	2	1-1/4	20
PI475	4	3	1-1/4	20
PI480	4	4	1-1/4	20

Light Duty



Heavy Duty



Heavy Duty

Heavy Duty Plain Milling Cutters 45°, Left Hand spiral - Right Hand cut.

Catalog No.	Cutter Diam.	Width	Hole Size	No. of Teeth
PH2501	2-1/2	2	1	8
PH2506	2-1/2	4	1	8
PH3010	3	1-1/4	1-1/4	8
PH3015	3	1-1/2	1-1/4	8
PH3020	3	2	1-1/4	8
PH3030	3	2-1/2	1-1/4	8
PH3040	3	3	1-1/4	8
PH3050	3	4	1-1/4	8
PH3060	3	6	1-1/4	8
PH4010	4	2	1-1/2	10
PH4020	4	3	1-1/2	10
PH4030	4	4	1-1/2	10
PH4040	4	6	1-1/2	10

Half Side Milling Cutters



Right Hand Milling Cutters

Catalog No.	Diam.	Width	Hole Size	No. of Teeth
HSM4750-RH	4	3/4	1-1/4	16
HSM5750-RH	5	3/4	1-1/4	18
HSM6750-RH	6	3/4	1-1/4	20
HSM6100-RH	6	1	1-1/2	20

Left Hand Milling Cutters

Catalog No.	Diam.	Width	Hole Size	No. of Teeth
HSM4750-LH	4	3/4	1-1/4	16
HSM5750-LH	5	3/4	1-1/4	18
HSM6750-LH	6	3/4	1-1/4	20
HSM6100-LH	6	1	1-1/2	20



Metal Slitting Saws – Straight Tooth

For Cobalt Saws, see page 32.
Saws with Full Radius, see page 21.

**CORNER RADIUS-ALTERED WIDTH
ALL TOOLS IN THIS CATALOG
CAN BE ALTERED AND SHIPPED
IN LESS THAN 48 HOURS**

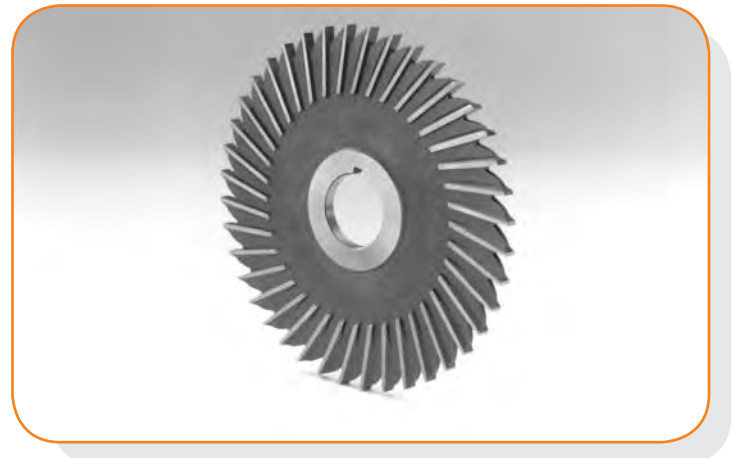

Straight Tooth - With Side Teeth

Catalog No.	Cutter Diam.	Width	Hole Size	No. of Teeth
SS2562	2-1/2	1/16	7/8	28
SS2593	2-1/2	3/32	7/8	28
SS25125	2-1/2	1/8	7/8	28
SS362	3	1/16	1	32
SS378	3	5/64	1	32
SS393	3	3/32	1	32
SS3109	3	7/64	1	32
SS3125	3	1/8	1	32
SS3125-1	3	1/8	1-1/4	32
SS3140	3	9/64	1	32
SS3156	3	5/32	1	32
SS3171	3	11/64	1	32
SS3187	3	3/16	1	32
SS3218	3	7/32	1	32
SS3250	3	1/4	1	32
SS462	4	1/16	1	36
SS462-1	4	1/16	1-1/4	36
SS478	4	5/64	1	36
SS478-1	4	5/64	1-1/4	36
SS493	4	3/32	1	36
SS493-1	4	3/32	1-1/4	36
SS4109	4	7/64	1	36
SS4109-1	4	7/64	1-1/4	36
SS4125	4	1/8	1	36
SS4125-1	4	1/8	1-1/4	36
SS4140	4	9/64	1	36
SS4140-1	4	9/64	1-1/4	36
SS4156	4	5/32	1	36
SS4156-1	4	5/32	1-1/4	36
SS4171	4	11/64	1	36
SS4171-1	4	11/64	1-1/4	36
SS4187	4	3/16	1	36
SS4187-1	4	3/16	1-1/4	36
SS4218	4	7/32	1	36
SS4218-1	4	7/32	1-1/4	36
SS4250	4	1/4	1	36
SS4250-1	4	1/4	1-1/4	36
SS562	5	1/16	1	40
SS562-1	5	1/16	1-1/4	40
SS593	5	3/32	1	40

Catalog No.	Cutter Diam.	Width	Hole Size	No. of Teeth
SS593-1	5	3/32	1-1/4	40
SS5109	5	7/64	1	40
SS5109-1	5	7/64	1-1/4	40
SS5125	5	1/8	1	40
SS5125-1	5	1/8	1-1/4	40
SS5140	5	9/64	1	40
SS5140-1	5	9/64	1-1/4	40
SS5156	5	5/32	1	40
SS5156-1	5	5/32	1-1/4	40
SS5171	5	11/64	1	40
SS5171-1	5	11/64	1-1/4	40
SS5187	5	3/16	1	40
SS5187-1	5	3/16	1-1/4	40
SS5218	5	7/32	1	40
SS5218-1	5	7/32	1-1/4	40
SS5250	5	1/4	1	40
SS5250-1	5	1/4	1-1/4	40
SS693	6	3/32	1	48
SS693-1	6	3/32	1-1/4	48
SS6109	6	7/64	1	48
SS6109-1	6	7/64	1-1/4	48
SS6125	6	1/8	1	48
SS6125-1	6	1/8	1-1/4	48
SS6140	6	9/64	1	48
SS6140-1	6	9/64	1-1/4	48
SS6156	6	5/32	1	48
SS6156-1	6	5/32	1-1/4	48
SS6171	6	11/64	1	48
SS6171-1	6	11/64	1-1/4	48
SS6187	6	3/16	1	48
SS6187-1	6	3/16	1-1/4	48
SS6218	6	7/32	1	48
SS6218-1	6	7/32	1-1/4	48
SS6250	6	1/4	1	48
SS6250-1	6	1/4	1-1/4	48
SS6375	6	3/8	1	48
SS6375-1	6	3/8	1-1/4	48
SS8125-1	8	1/8	1-1/4	42
SS8187-1	8	3/16	1-1/4	42
SS8250-1	8	1/4	1-1/4	42

Metal Slitting Saws – Staggered Tooth

For Cobalt Saws, see page 32.

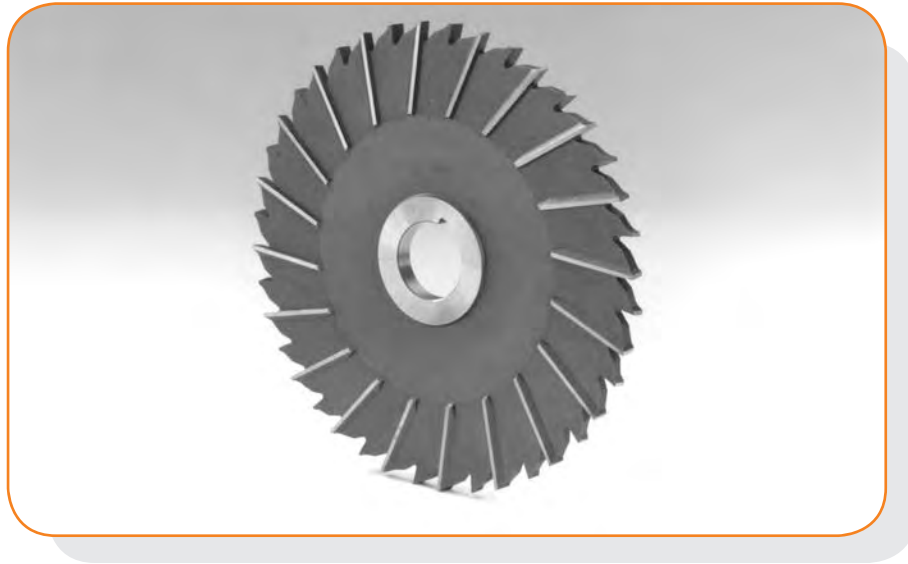

Staggered Tooth

The staggered tooth metal slitting saws have side chip clearance and peripheral teeth which provide an alternative shearing action. This allows for faster chip removal and deeper cuts when a heavy feed is necessary.

Catalog No.	Cutter Diam.	Width	Hole Size	No. of Teeth
STS362	3	1/16	1	28
STS378	3	5/64	1	28
STS393	3	3/32	1	28
STS3109	3	7/64	1	28
STS3125	3	1/8	1	28
STS3140	3	9/64	1	28
STS3156	3	5/32	1	28
STS3171	3	11/64	1	28
STS3187	3	3/16	1	28
STS3218	3	7/32	1	28
STS3250	3	1/4	1	28
STS462	4	1/16	1	32
STS478	4	5/64	1	32
STS493	4	3/32	1	32
STS4109	4	7/64	1	32
STS4125	4	1/8	1	32
STS4125-1	4	1/8	1-1/4	32
STS4140	4	9/64	1	32
STS4156	4	5/32	1	32
STS4156-1	4	5/32	1-1/4	32
STS4171	4	11/64	1	32
STS4171-1	4	11/64	1-1/4	32
STS4187	4	3/16	1	32
STS4187-1	4	3/16	1-1/4	32
STS4218	4	7/32	1	32
STS42118-1	4	7/32	1-1/4	32
STS4250	4	1/4	1	32
STS593	5	3/32	1	36

Catalog No.	Cutter Diam.	Width	Hole Size	No. of Teeth
STS5125	5	1/8	1	36
STS5125-1	5	1/8	1-1/4	36
STS5140	5	9/64	1	36
STS5156	5	5/32	1	36
STS5156-1	5	5/32	1-1/4	36
STS5171	5	11/64	1	36
STS5187	5	3/16	1	36
STS5187-1	5	3/16	1-1/4	36
STS5218	5	7/32	1	36
STS5218-1	5	7/32	1-1/4	36
STS5250	5	1/4	1	36
STS5250-1	5	1/4	1-1/4	36
STS6125	6	1/8	1	40
STS6125-1	6	1/8	1-1/4	40
STS6140	6	9/64	1	40
STS6140-1	6	9/64	1-1/4	40
STS6156	6	5/32	1	40
STS6156-1	6	5/32	1-1/4	40
STS6171	6	11/64	1	40
STS6187	6	3/16	1	40
STS6187-1	6	3/16	1-1/4	40
STS6218	6	7/32	1	40
STS6218-1	6	7/32	1-1/4	40
STS6250	6	1/4	1	40
STS6250-1	6	1/4	1-1/4	40
STS8125	8	1/8	1	48
STS8125-1	8	1/8	1-1/4	48
STS8187-1	8	3/16	1-1/4	48
STS8250-1	8	1/4	1-1/4	48

Plain Metal Slitting Saws

Concave Sides Without Side Teeth

These saws are made with a standard keyway and the sides are ground concave to a hub for clearance. It is recommended that these saws be revolved by a key extending into the collars on both sides.



**CORNER RADIUS-ALTERED WIDTH
ALL TOOLS IN THIS CATALOG
CAN BE ALTERED AND SHIPPED
IN LESS THAN 48 HOURS**

Catalog No.	Cutter Diam.	Width	Hole Size	No. of Teeth
PS2531	2-1/2	1/32	7/8	28
PS2548	2-1/2	3/64	7/8	28
PS2562	2-1/2	1/16	7/8	28
PS2593	2-1/2	3/32	7/8	28
PS25125	2-1/2	1/8	7/8	28
PS331	3	1/32	1	32
PS348	3	3/64	1	32
PS362	3	1/16	1	32
PS378	3	5/64	1	32
PS393	3	3/32	1	32
PS3109	3	7/64	1	32
PS3125	3	1/8	1	32
PS3140	3	9/64	1	32
PS3156	3	5/32	1	32
PS3171	3	11/64	1	32
PS3187	3	3/16	1	32
PS431	4	1/32	1	36
PS446	4	3/64	1	36
PS462	4	1/16	1	36
PS478	4	5/64	1	36
PS493	4	3/32	1	36
PS493-1	4	3/32	1	36
PS4109	4	7/64	1	36
PS4125	4	1/8	1	36
PS4140	4	9/64	1	36
PS4156	4	5/32	1	36
PS4171	4	11/64	1	36
PS4187	4	3/16	1	36
PS562	5	1/16	1	40
PS578	5	5/64	1	40
PS593	5	3/32	1	40
PS593-1	5	3/32	1 1/4	40
PS5109	5	7/64	1	40
PS5125	5	1/8	1	40
PS5125-1	5	1/8	1-1/4	40
PS5140	5	9/64	1	40
PS5140-1	5	9/64	1-1/4	40
PS5156	5	5/32	1	40
PS5171	5	11/64	1	40
PS5187	5	3/16	1	40
PS678	6	5/64	1	48
PS693	6	3/32	1	48
PS6125	6	1/8	1	48
PS6125-1	6	1/8	1-1/4	48
PS6187	6	3/16	1	48
PS6187-1	6	3/16	1-1/4	48
PS8125	8	1/8	1	48
PS8125-1	8	1/8	1-1/4	48

Cobalt Slitting Saws – Straight Tooth

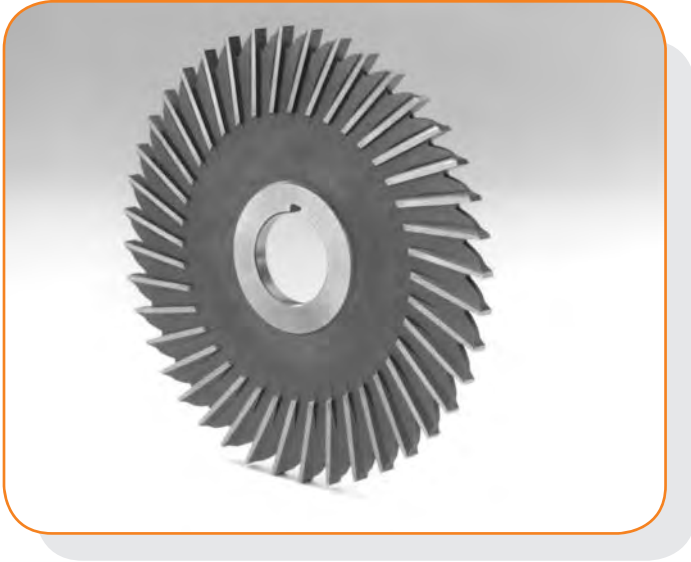

For Full Radius, see page 21.

Catalog No.	Cutter Diam.	Width	Hole Size
CSS362	3	1/16	1
CSS393	3	3/32	1
CSS3125	3	1/8	1
CSS3156	3	5/32	1
CSS3171	3	11/64	1
CSS3187	3	3/16	1
CSS3218	3	7/32	1
CSS3250	3	1/4	1
CSS3281	3	9/32	1
CSS462	4	1/16	1
CSS462-1	4	1/16	1-1/4
CSS493	4	3/32	1
CSS493-1	4	3/32	1-1/4
CSS4125	4	1/8	1
CSS4125-1	4	1/8	1-1/4
CSS4140	4	9/64	1
CSS4156	4	5/32	1
CSS4156-1	4	5/32	1-1/4
CSS4187	4	3/16	1
CSS4187-1	4	3/16	1-1/4
CSS4250	4	1/4	1
CSS4250-1	4	1/4	1-1/4
CSS6125-1	6	1/8	1-1/4
CSS6156-1	6	5/32	1-1/4
CSS6187-1	6	3/16	1-1/4
CSS6250-1	6	1/4	1-1/4

Cobalt Slitting Saws – Staggered Tooth

For Full Radius, see page 21.

Catalog No.	Cutter Diam.	Width	Hole Size
CSTS3125	3	1/8	1
CSTS3156	3	5/32	1
CSTS3187	3	3/16	1
CSTS3250	3	1/4	1
CSTS4125	4	1/8	1
CSTS4125-1	4	1/8	1-1/4
CSTS4140	4	9/64	1
CSTS4156	4	5/32	1
CSTS4156-1	4	5/32	1-1/4
CSTS4187	4	3/16	1
CSTS4187-1	4	3/16	1-1/4
CSTS4250	4	1/4	1
CSTS4250-1	4	1/4	1-1/4
CSTS6125-1	6	1/8	1-1/4
CSTS6156-1	6	5/32	1-1/4
CSTS6187-1	6	3/16	1-1/4
CSTS6250-1	6	1/4	1-1/4

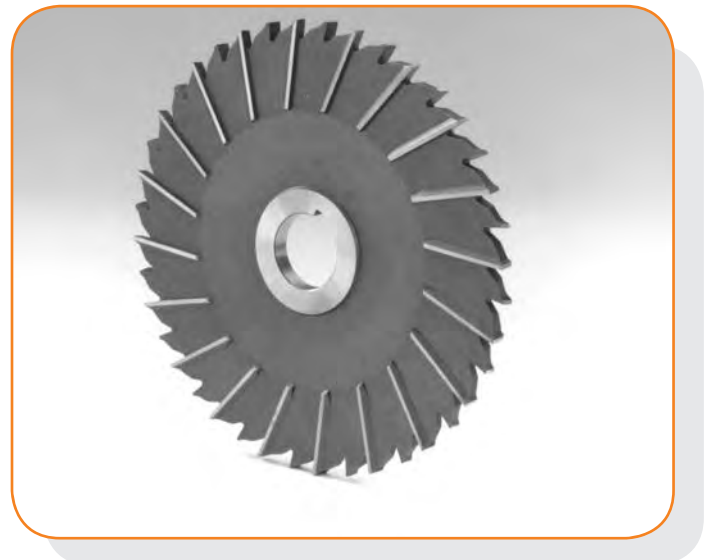

SHANK TYPE SPECIALS

**PLEASE FILL OUT AND FAX TO 203-281-4197
FOR A QUICK QUOTATION**

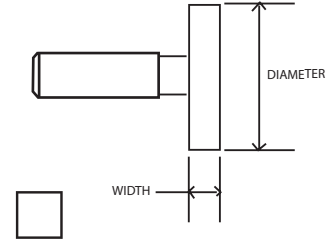
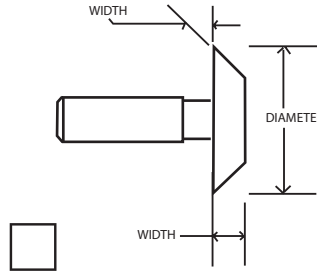
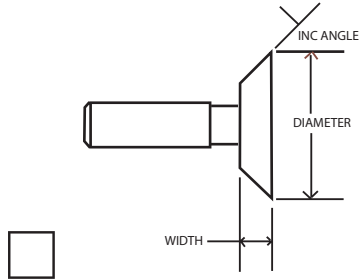

DIMENSION: Diameter _____
 Width _____
 Inc Angle _____
 Shank Dia _____
 Radius _____
 Number of Teeth _____

MATERIAL : High Speed Steel
 M-42 Cobalt
 T-15 Cobalt
 Carbide Tipped

COATING : TiN
 TiALN
 TiCN
 UnCoated

QUANTITY : ONE
 TWO
 THREE
 SIX
 TWELVE
 OTHER _____

Tooth Style : Straight Tooth
 Staggered Tooth
 Right Hand
 Left Hand
Side Teeth : With Side Teeth
 Without Side Teeth

Use this grid to draft your cutter.
Please provide any special features and dimensions.

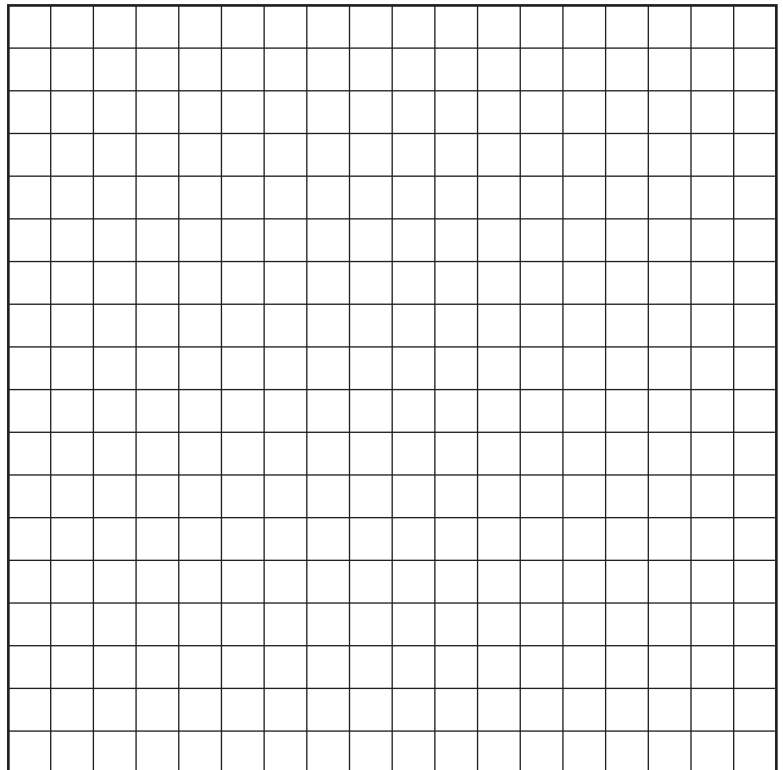

COMPANY NAME _____ **PHONE** _____

CONTACT NAME _____ **FAX** _____

FEEDS & SPEEDS

Feeds & speeds are a starting recommendation only. Factors such as machine, fixture and tooling rigidity, horsepower available, coolant application and others will affect the performance significantly. Please read machine operators instructions and use all safety shields and glasses before performing these operations.

MAT CLASS	MATERIAL	BRINELL	CARB SIDEMILLING		HSS SIDEMILLING		CARB KEYSEATING		HSS KEYSEATING	
			SFPM	IPT	SFPM	IPT	SFPM	IPT	SFPM	IPT
NON FERROUS SOFT	ALUMINUM ALLOY-WROUGHT	30/150	1000-2000	.004-.008	600-700	.002-.007	1200	.002-.006	600-700	.002-.007
	MAGNESIUM ALLOY	50/90	750-1500	.004-.008	400-500	.002-.007	1000	.002-.006	400-500	.002-.007
	NON METAL-PLASTIC	XXX	1500-3000	.004-.008	800-1000	.002-.007	1500	.002-.006	800-1000	.002-.007
	ZINC ALLOY-CAST	80/100	750-15000	.004-.008	400-500	.002-.007	750-1000	.002-.006	400-500	.002-.007
NON FERROUS HARD	ALUMINUM BRONZE	40/175	200-600	.005-.010	100-300	.002-.007	200-600	.002-.006	100-300	.002-.007
	BRASS ALLOY FREE CUTTING - LEADED	10/100	400-800	.003-.006	175-400	.002-.007	400-550	.002-.006	175-400	.002-.007
	NICKEL SILVER	10/100	200-400	.004-.008	70-150	.002-.007	200-400	.002-.006	70-150	.002-.007
	COPPER ALLOY TOUGH	40/200	200-500	.003-.006	80-175	.002-.007	200-500	.002-.006	80-175	.002-.007
CAST IRONS	DUCTILE CAST IRON-AUSTENITIC	120/275	75-150	.004-.008	40-60	.001-.005	75-150	.002-.006	40-60	.001-.005
	DUCTILE CAST IRON-FERRITIC	140/270	250-400	.002-.004	40-60	.001-.005	200-400	.002-.006	40-60	.001-.005
	DUCTILE CAST IRON-MARTENSITIC	270/440	250-300	.003-.006	40-60	.001-.005	150-350	.002-.006	40-60	.001-.005
	GREY-PEARLITIC	220/320	120-300	.002-.004	40-60	.001-.005	150-300	.002-.006	40-60	.001-.005
	GRAY-FERRITIC	110/240	250-425	.003-.006	40-60	.001-.005	220-410	.002-.006	40-60	.001-.005
	MALLEABLE CAST IRON-MARTENSIC	200/320	130-225	.002-.004	100-130	.001-.005	130-300	.002-.006	100-130	.001-.005
LOW CARBON STEELS	LOW AND MEDIUM CARBON-FREE MACH	100/250	250-500	.003-.006	50-70	.001-.005	200-500	.001-.005	50-70	.001-.005
	LOW AND MEDIUM CARBON-WROUGHT	100/375	200-400	.002-.004	30-40	.001-.005	200-400	.001-.005	30-40	.001-.005
MEDIUM STRENGTH STEEL	LOW AND MEDIUM CARBON ALLOY-FREE	100/275	200-400	.002-.004	15-45	.001-.005	200-400	.001-.005	15-45	.001-.005
	LOW AND MEDIUM CARBON ALLOY-STEEL	85/375	150-300	.002-.004	30-35	.001-.005	130-330	.001-.005	30-35	.001-.005
	STAINLESS 400	135/325	200-400	.002-.004	15-45	.0005-.002	135-375	.001-.005	15-45	.0005-.002
	STAINLESS 400-FREE MACHINING	135/275	250-500	.003-.006	15-45	.0005-.002	250-500	.001-.005	15-45	.0005-.002
HIGH STRENGTH	HIGH STRENGTH STEEL-WROUGHT-TOOL	175/400	75-150	.003-.006	10-15	.0005-.002	75-200	.001-.004	10-15	.0005-.002
HIGH TEMP ALLOYS	HIGH TEMP NICKEL/IRON BASE ALLOY	140/300	50-150	.002-.004	5-20	.0005-.002	50-150	.001-.004	5-20	.0005-.002
	STAINLESS STEEL-300 SERIES	135/375	75-150	.002-.004	15-25	.0005-.002	75-175	.001-.004	15-25	.0005-.002
	STAINLESS-PH SERIES	150/440	75-150	.002-.004	15-25	.0005-.002	75-175	.001-.004	15-25	.0005-.002
	TITANIUM ALLOY	110/380	100-200	.002-.004	15-25	.0005-.002	75-200	.001-.004	15-25	.0005-.002

RPM = SFPM X 3.82 / CUTTER DIAMETER

IPM = IPT X RPM X # TEETH

IPT = INCHES PER TOOTH

IPM = INCHES PER MINUTE

RPM = REVOLUTION PER MINUTE

SFPM = SURFACE FEET PER MINUTE

CUTTER DIAMETER = DIAMETER OF CUTTER IN INCHES

Take
advantage of

Just-In-Time Tooling

There's no reason for you to order special cutters long in advance of your actual need for them, not when you have Moon Cutter to lean on.

You'll be leaning on Moon's expertise in design and production – more than forty years of it. Our complete in-house capabilities (which also include heat treating) enable us to deliver the finest quality "specials" almost as fast as you can design them.

And you'll get them for just-in-time tooling...you can depend on it!

Standard Cutters In Stock!

Main Office:

Moon Cutter Company, Inc.
2969 State Street
Hamden, Connecticut 06517

Toll Free: 1-800-243-2035
Telephone: 203-288-9249
Fax: 203-281-4197

West Coast Warehouse:

M.C. Sales and Marketing
Huntington Beach, California

Toll Free: 1-888-299-8665
Telephone: 714-901-8589
Fax: 714-901-8579



MOON
Cutter Co., Inc.

2969 State Street • Hamden, CT 06517
Telephone: 1-800-243-2035 • 203-288-9249
Fax: 203-281-4197 • www.mooncutter.com